

**D-1500**  
**D-1501**  
**D-1502**

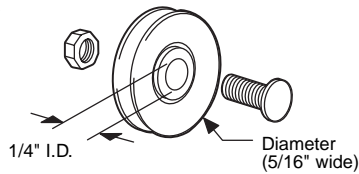

**D-1795**  
**D-1796**  
**D-1797**

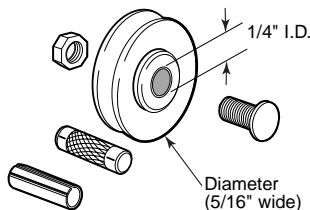

**D-1854** **D-1838**  
**D-1765** **D-1839**  
**D-1766** **D-1787**

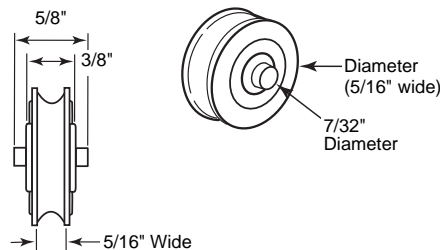

**D-1867**  
**D-1868**  
**D-1869**

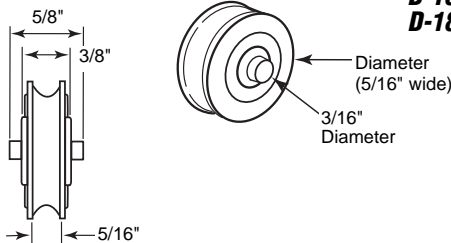

**D-1692**  
**D-1693**  
**D-1694**

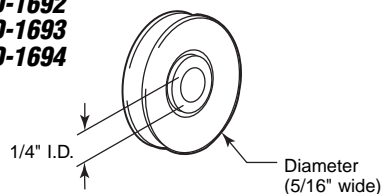

**D-1703**  
**D-1704**  
**D-1705**  
**D-1706**

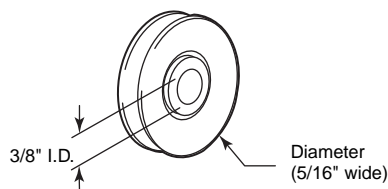

**D-1500** (1")  
**D-1501** (1-1/8")  
**D-1502** (1-1/4")

## Roller (Steel)

**Contents:** 2 rollers; installation bolts.

**Description:** Steel ball bearing roller; steel inner race with 1/4" hole; center grooved; universal design.

**D-1795** (1-1/8")  
**D-1796** (1-1/4")  
**D-1797** (1-1/2")

## Roller (Steel)

**Contents:** 2 rollers; 2 axle pins; 2 roll pins; 2 carriage bolts with nuts.

**Description:** Steel ball bearing roller; steel inner race with 1/4" hole; center grooved; universal design.

**D-1854** (1-1/8" Steel) **D-1838** (1-1/8" Stainless steel)  
**D-1765** (1-1/4" Steel) **D-1839** (1-1/4" Stainless steel)  
**D-1766** (1-1/2" Steel) **D-1787** (1-1/2" Stainless steel)

## Roller

**Contents:** 2 rollers.

**Description:** Ball bearing roller; built-in axle; center grooved; universal design.

**D-1867** (1-1/8")  
**D-1868** (1-1/4")  
**D-1869** (1-1/2")

## Roller (Nylon)

**Contents:** 2 rollers.

**Description:** Nylon ball bearing roller; built in axle; center grooved; universal design.

**D-1692** (1-1/8")  
**D-1693** (1-1/4")  
**D-1694** (1-1/2")

## Roller (Stainless steel)

**Contents:** 2 rollers.

**Description:** Stainless steel ball bearing rollers; used in severe weather environments where corrosion is a problem.

**D-1703** (1-1/4" Steel)  
**D-1704** (1-1/2" Steel)  
**D-1705** (1-1/4" Nylon)  
**D-1706** (1-1/2" Nylon)

## Roller or Pulley Roller

**Contents:** 2 roller assemblies.

**Description:** Ball bearing roller with 3/8" inside diameter axle hole; used for pulleys and patio doors where a 3/8" axle bolt is required.

## D-1503

### Roller (Steel)

**Contents:** 2 rollers.

**Description:** Steel ball bearing roller; steel inner race with 1/4" hole; center grooved; **universal design**.

## D-1503

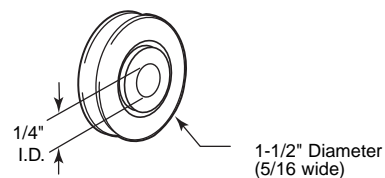

## D-1709

### Roller (Steel)

**Contents:** 2 rollers.

**Description:** Steel ball bearing roller with 1/2" wide hub. Replacement unit for Part No. **D-1578**.

## D-1709

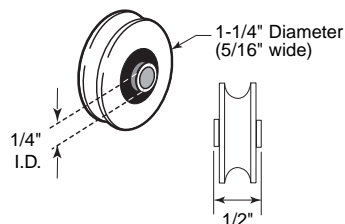

## D-1760

### Roller (Flat steel)

**Contents:** 2 rollers; installation bolts.

**Description:** Flat steel ball bearing roller; with 1/4" hole; universal design.

## D-1760

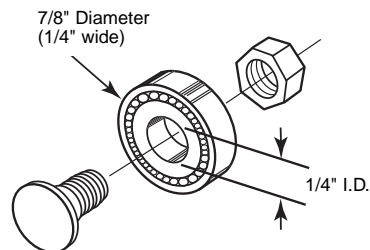

## D-1712

### Roller (Steel)

**Contents:** 2 rollers.

**Description:** Flat steel ball bearing roller with wide hub and 1/4" hole.

## D-1712

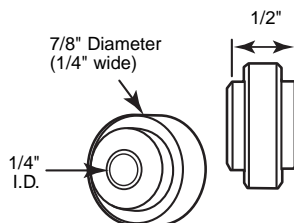

## D-1506

**D-1799** (With axles; roll pins; bolts and nuts)

### Roller (Nylon)

**Contents:** 2 rollers.

**Description:** Nylon ball bearing roller; steel inner race with 1/4" hole; center grooved; universal design.

## D-1506

## D-1799

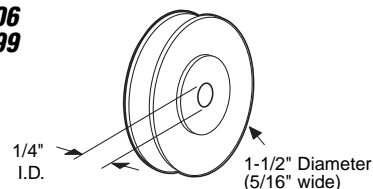

## D-1507

**D-1800** (With axles; roll pins; bolts and nuts)

### Roller (Nylon)

**Contents:** 2 rollers.

**Description:** Nylon ball bearing roller; steel inner race with 1/4" hole; center grooved; universal design.

## D-1507

## D-1800

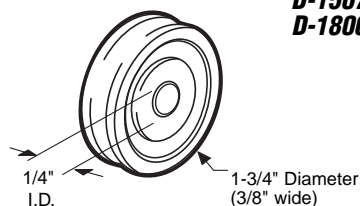

## D-1725

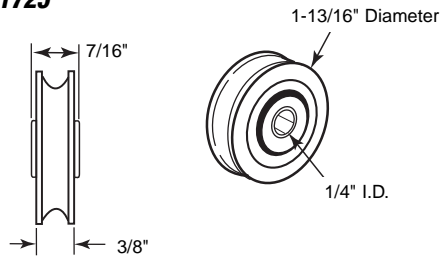

## D-1725

### Roller (Steel)

**Contents:** 2 rollers.

**Description:** Steel ball bearing roller; steel inner race; 7/16" wide with 1/4" hole; center grooved.

## D-1567

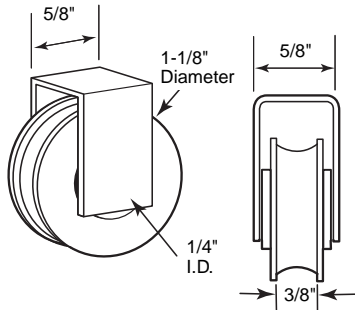

## D-1567

### Roller (Steel)

**Contents:** 2 rollers with nylon housings.

**Description:** Steel ball bearing roller; fits on *Horizon* and other patio door manufacturers.

## D-1713

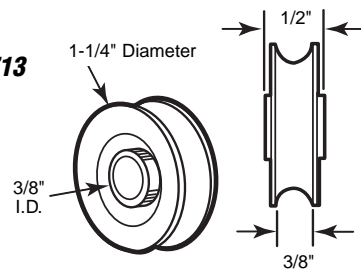

## D-1713

### Roller (Nylon)

**Contents:** 2 rollers.

**Description:** Nylon roller; center grooved; universal design.

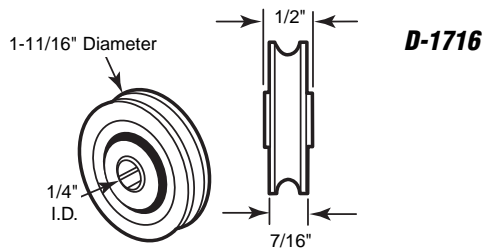

## D-1716

### Roller (Nylon)

**Contents:** 2 rollers.

**Description:** Nylon ball bearing roller with steel inner race; center grooved wheel; universal design.

## D-1504 D-1865

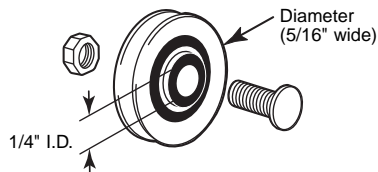

## D-1865 (1-1/8")

## D-1504 (1-1/4")

### Roller (Nylon)

**Contents:** 2 rollers; installation bolts.

**Description:** Nylon ball bearing roller; steel inner race with 1/4" hole; center grooved; universal design.

## D-1798

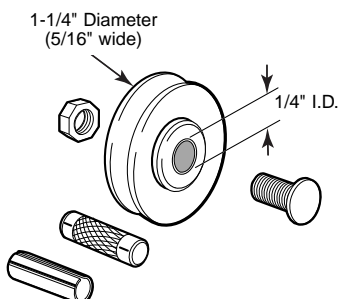

## D-1798

### Roller (Nylon)

**Contents:** 2 rollers; 2 axle pins; 2 roll pins; installation bolts.

**Description:** Nylon ball bearing roller; steel inner race with 1/4" hole; center grooved; universal design.

## D-1505

### Roller (Nylon)

**Contents:** 2 rollers; 2 axle assemblies w/locking screws.

**Description:** Nylon ball bearing roller; steel inner race with 1/4" off-center hole for vertical adjustment; universal design.

## D-1505

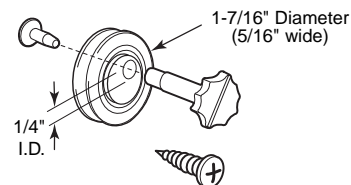

## D-1641

### Roller Assembly (Flat nylon)

**Contents:** 2 roller assemblies.

**Description:** Flat nylon ball bearing roller only; for replacement onto existing diecast top bracket; fits on *Harrow*.

Call for  
Availability

## D-1641

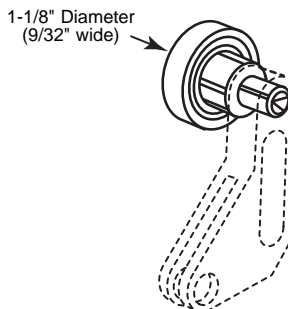

## D-1638 (Steel)

## D-1639 (Nylon)

### Roller

**Contents:** 2 rollers.

**Description:** Ball bearing roller; steel inner race with 3/16" hole; universal design.

## D-1638 D-1639

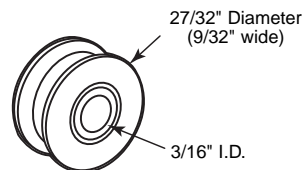

## D-1642

### Axle Pin Assortment

**Contents:** 2-.625" long pins; 2-.710" long pins; 2-.810" long pins.

**Description:** Axle pins are zinc plated; knurled surface for tight fit; 3 most popular sizes.

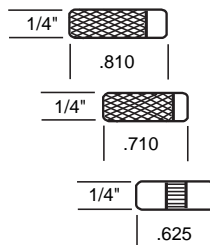

## D-1642

## D-1861

### Door Roller Axle Repair Kit

**Contents:** 2 stepped axles; 2 roll pins; 2 standard 1/4" rivets; 2-1/4"-20 carriage bolts; 2-1/4"-20 hex nuts; 2- binder posts and screws.

**Description:** Axle repair kit for patio doors.

## D-1861

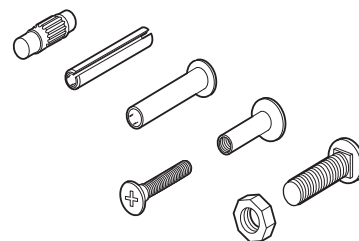

## D-1509

### Roller Assembly

**Contents:** 1 roller assembly.

**Description:** Steel ball bearing roller; adjustable steel housing assembly; fits on *Sun Valley*, *Fullview*, *Glasco* and other patio door manufacturers.

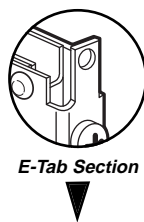

## Old Style

## D-1509

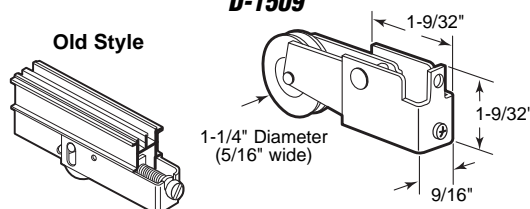

## D-1558

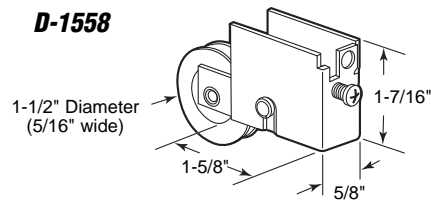

## D-1558

### Roller Assembly

**Contents:** 1 roller assembly.

**Description:** Nylon ball bearing roller; adjustable steel housing assembly; fits on *Marshall* and other patio door manufacturers.

## D-1528

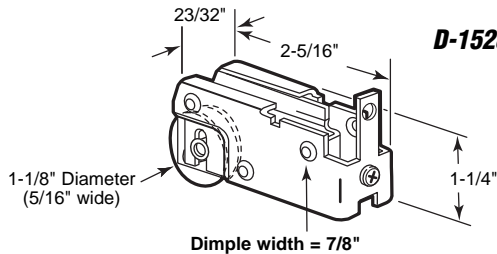

## D-1528

### Roller Assembly

**Contents:** 1 roller assembly.

**Description:** Steel ball bearing roller; adjustable steel housing assembly; used by several patio door manufacturers.

## D-1540 D-1729

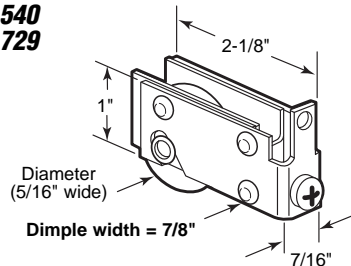

**D-1540** (1-1/8" Steel)

**D-1729** (1-1/4" Steel)

### Roller Assembly

**Contents:** 1 roller assembly.

**Description:** Steel ball bearing roller; adjustable steel housing assembly; fits on *Viking* and other patio door manufacturers.

## D-1553 D-1844

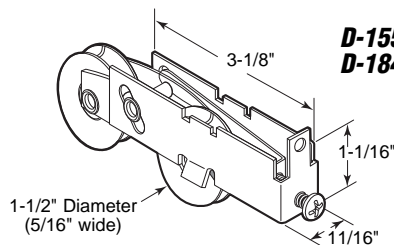

**D-1553** (Nylon)

**D-1844** (Steel)

### Tandem Roller Assembly

**Contents:** 1 roller assembly.

**Description:** Tandem ball bearing rollers; adjustable steel housing assembly; fits on *Fleetwood* and other patio manufacturers.

## D-1510 D-1511

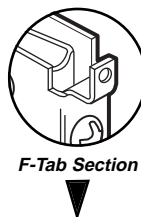
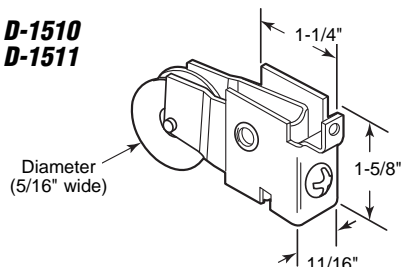

**D-1510** (1-1/4")

**D-1511** (1-1/2")

### Roller Assembly

**Contents:** 1 roller.

**Description:** Nylon ball bearing roller; adjustable steel housing assembly; fits on *Starlite*, *Doormaster* and other patio door manufacturers.

## D-1772

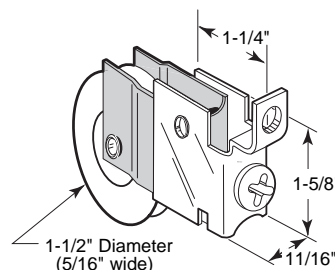

## D-1772

### Roller Assembly

**Contents:** 1 roller assembly.

**Description:** Steel ball bearing roller; adjustable steel housing assembly; fits on *Starlite*, *Doormaster* and other patio door manufacturers. This roller is riveted on.

## D-1514

### Roller Assembly

**Contents:** 1 roller assembly.

**Description:** Steel ball bearing roller; adjustable steel housing assembly; fits on *Christian Porter* and other patio door manufacturers.

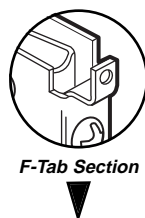

F-Tab Section

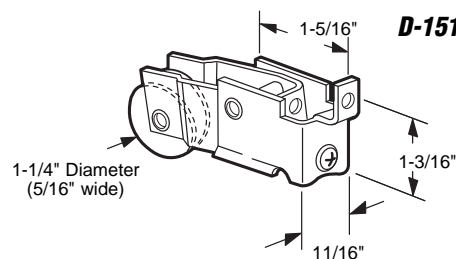

D-1514

## D-1520

### Roller Assembly

**Contents:** 1 roller assembly.

**Description:** Nylon ball bearing roller; adjustable steel housing assembly; fits on *Ador/HiLite* and other patio door manufacturers; replaces old-style diecast assembly.

D-1520

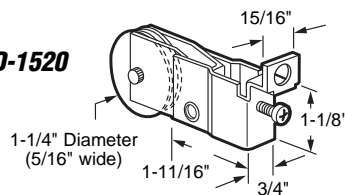

Old Style

## D-1686 (1-1/4")

## D-1740 (1-1/2")

### Roller Assembly

**Contents:** 1 roller assembly.

**Description:** Steel ball bearing roller; adjustable steel housing assembly; used by several patio door manufacturers.

D-1686  
D-1740

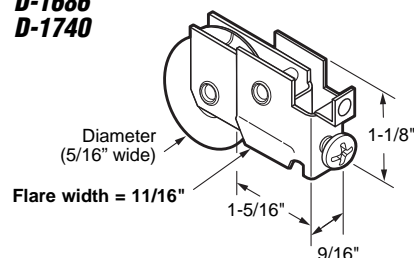

## D-1578 (1-1/4")

## D-1790 (1-1/2")

### Roller Assembly

**Contents:** 1 roller assembly.

**Description:** Steel ball bearing roller; adjustable steel housing assembly; used by several patio door manufacturers.

You may also wish to stock these related parts: D-1709.

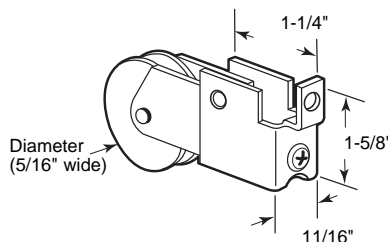

D-1578  
D-1790

## D-1515

### Roller Assembly

**Contents:** 1 roller assembly.

**Description:** Steel ball bearing roller; adjustable steel housing assembly; fits on *Christian Porter*, *Fullview* and other patio door manufacturers.

D-1515

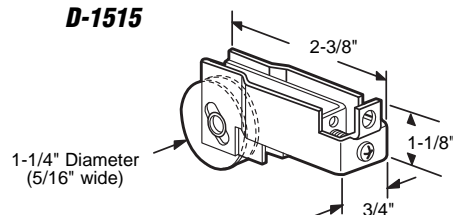

## D-1773

### Roller Assembly

**Contents:** 1 roller assembly.

**Description:** Steel ball bearing roller; adjustable steel housing assembly. Inner and outer housing is held together with a flush pin (not a rivet); has smooth sides, no flares. Fits on *Superlite Mfg.*

D-1773

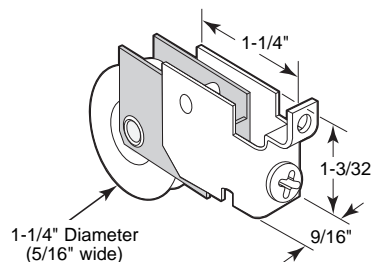

## D-1699

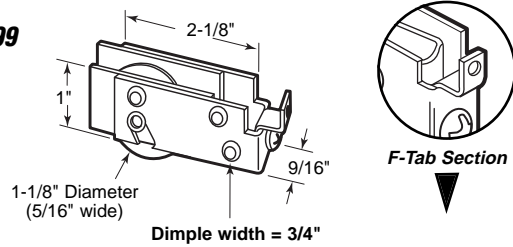

## D-1699

### Roller Assembly

**Contents:** 1 roller assembly.

**Description:** Steel ball bearing roller; adjustable steel housing assembly; used by several patio door manufacturers.

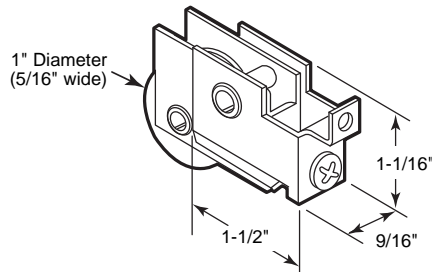

## D-1753

## D-1753

### Roller Assembly

**Contents:** 1 roller assembly.

**Description:** Steel ball bearing roller; adjustable steel housing assembly; used by several patio door manufacturers.

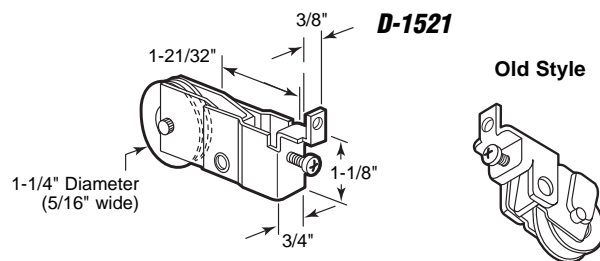

## D-1521

## D-1521

### Roller Assembly

**Contents:** 1 roller assembly.

**Description:** Nylon ball bearing roller; adjustable steel housing assembly; replaces old-style diecast assembly; fits on *Ador/HiLite* and other patio door manufacturers.

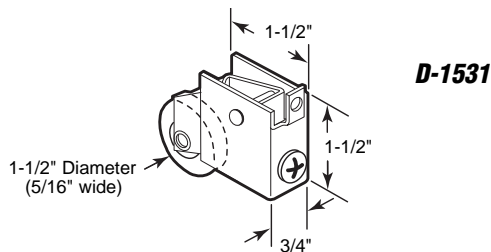

## D-1531

## D-1531

### Roller Assembly

**Contents:** 1 roller assembly.

**Description:** Steel ball bearing roller; adjustable steel housing assembly; fits on *Hollyview*, *Fullview* and other patio door manufacturers.

## D-1584 D-1733

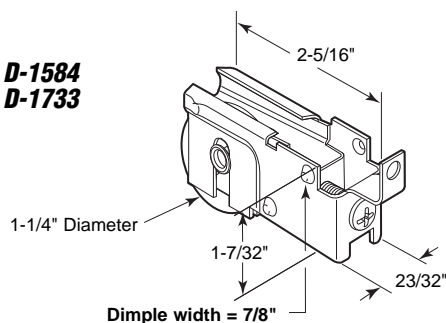

## D-1584 (Steel)

## D-1733 (Nylon)

### Roller Assembly

**Contents:** 1 roller assembly.

**Description:** Ball bearing roller; adjustable steel housing assembly; fits on *Northrop* and other patio door manufacturers.

## D-1815

### Roller Assembly

**Contents:** 1 roller assembly.

**Description:** Nylon ball bearing roller; adjustable steel housing assembly; fits on *King Mirror Door Co.*

## D-1519

(1-1/4" Steel)

## D-1870

(1-1/2" Nylon)

### Roller Assembly

**Contents:** 1 roller assembly.

**Description:** Ball bearing roller; adjustable steel housing assembly; used by several patio door manufacturers; will replace old style **Cupples** door roller.

## D-1530

### Roller Assembly

**Contents:** 1 roller assembly.

**Description:** Steel ball bearing roller; adjustable steel housing assembly; fits on *Schooner* and other patio door manufacturers.

## D-1776

### Roller Assembly

**Contents:** 1 roller assembly.

**Description:** Steel ball bearing roller; adjustable steel housing assembly; fits on *Guaranteed Products* and *The Jordon Company*.

## D-1811

### Roller Assembly

**Contents:** 1 roller assembly.

**Description:** Steel ball bearing roller; adjustable steel housing; fits on *Northrop* series 600 door.

## D-1840

### Roller Assembly

**Contents:** 1 roller assembly.

**Description:** Steel ball bearing; adjustable steel housing assembly. Fits on *Guaranteed Products*.

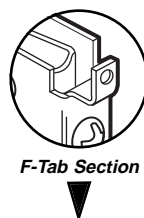

F-Tab Section

## D-1815

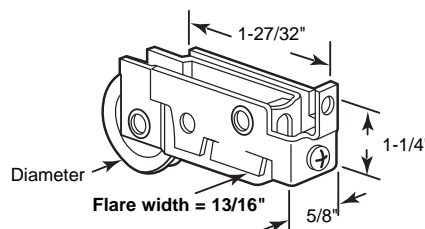
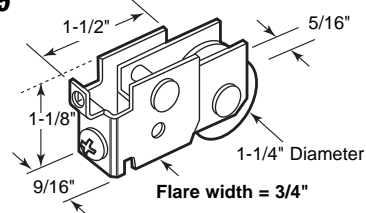

## D-1519 D-1870

## D-1530

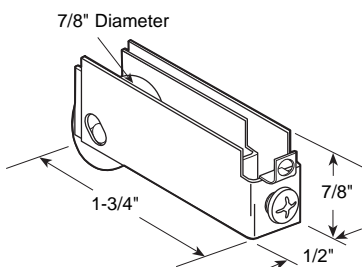
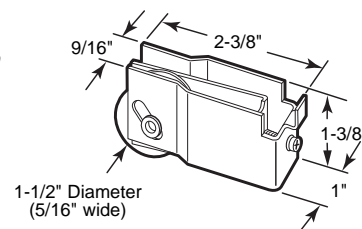

## D-1776

## D-1811

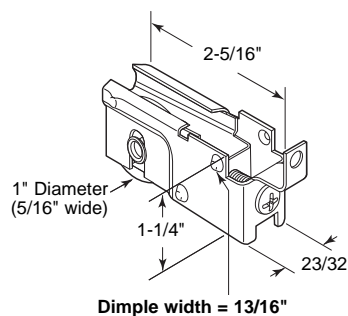
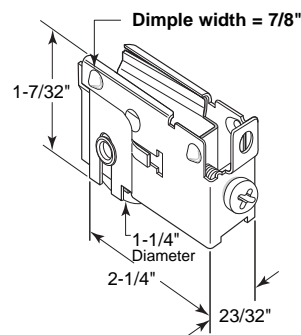

## D-1840



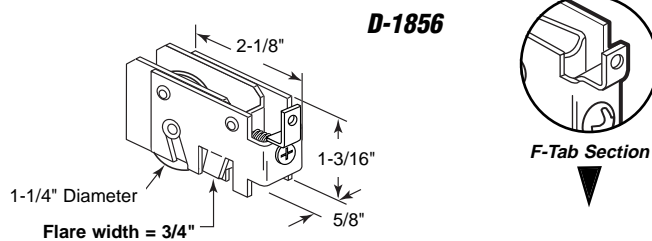

## D-1856

### Roller Assembly

**Contents:** 1 roller assembly.

**Description:** Ball bearing roller assembly; adjustable steel housing; fits on *Rylock*.

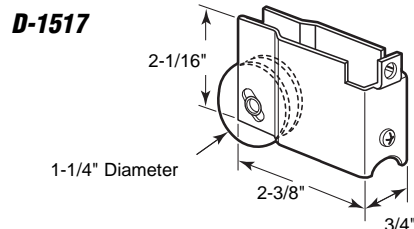

## D-1517

### Roller Assembly

**Contents:** 1 roller assembly.

**Description:** Steel ball bearing roller; adjustable steel housing assembly; fits on *Mid-Continent* and other patio door manufacturers.

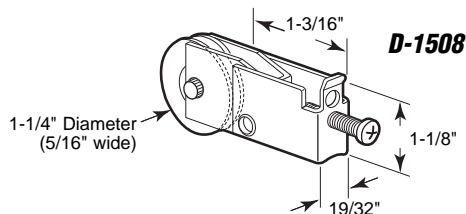

## D-1508

### Roller Assembly

**Contents:** 1 roller.

**Description:** Nylon ball bearing roller; adjustable steel housing assembly; used by several patio door manufacturers.

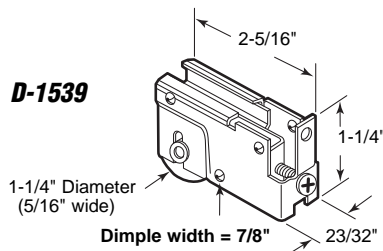

## D-1539

### Roller Assembly

**Contents:** 1 roller assembly.

**Description:** Nylon ball bearing roller; adjustable steel housing assembly; fits on *Lupton* and other patio door manufacturers.

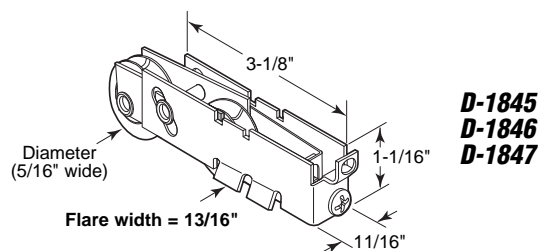

## D-1737

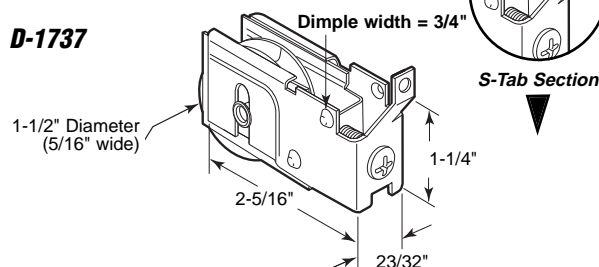

**D-1845** (1-1/4" Steel)

**D-1846** (1" Steel)

**D-1847** (1-1/8" Steel)

### Tandem Roller Assembly

**Contents:** 1 roller assembly.

**Description:** Tandem steel ball bearing rollers; adjustable steel housing assembly; fits on *Guaranteed Products* and other patio door manufacturers.

## D-1737

### Roller Assembly

**Contents:** 1 roller assembly.

**Description:** Nylon ball bearing roller; adjustable steel housing assembly.

## D-1862

### Roller Assembly

**Contents:** 1 roller assembly.

**Description:** Tandem steel ball bearing roller assembly; adjustable steel housing; fits on *Fleetwood* on the high-rise series.

## D-1738

### Roller Assembly

**Contents:** 1 roller assembly.

**Description:** Tandem nylon ball bearing rollers; adjustable steel housing assembly.

## D-1526

### Roller Assembly

**Contents:** 1 roller assembly.

**Description:** Steel ball bearing roller; adjustable steel housing; fits on *Pacific* and other patio door manufacturers.

## D-1527

### Roller Assembly

**Contents:** 1 roller assembly.

**Description:** Steel ball bearing roller; adjustable steel housing assembly; fits on *Solar Ind.* and other patio door manufacturers.

## D-1588 (1-1/2" Steel)

## D-1589 (1-1/2" Nylon)

## D-1756 (1-1/4" Steel)

## D-1817 (1-1/4" Nylon)

### Roller Assembly

**Contents:** 1 roller assembly.

**Description:** Ball bearing roller; adjustable steel housing assembly; fits on *Window Master* and other patio door manufacturers.

## D-1690 (Nylon)

## D-1691 (Steel)

### Roller Assembly

**Contents:** 1 roller assembly.

**Description:** Ball bearing roller assembly; adjustable steel housing; fits on *Ador/HiLite* on the high-rise series.

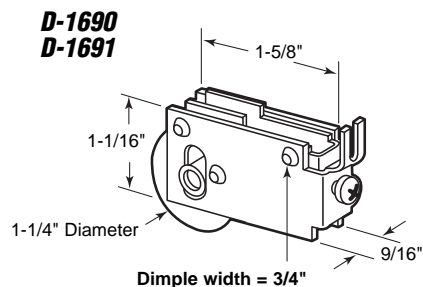
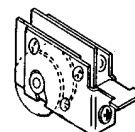
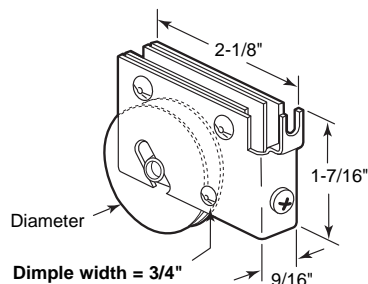
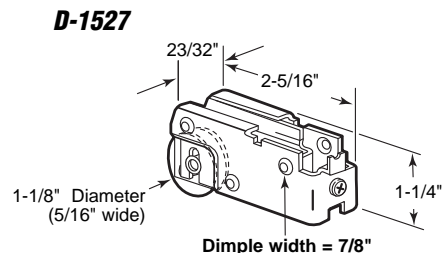
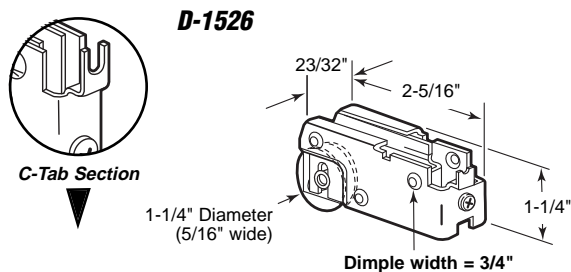
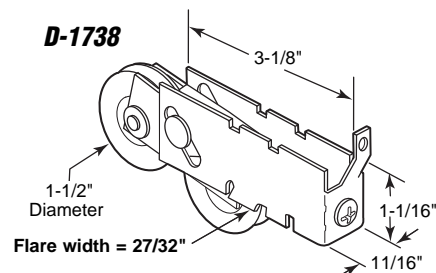
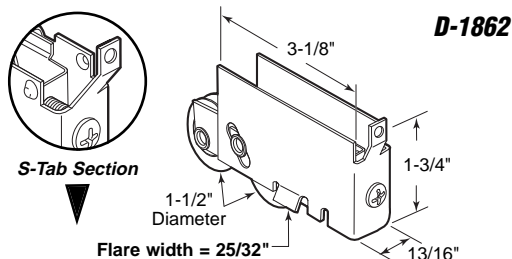

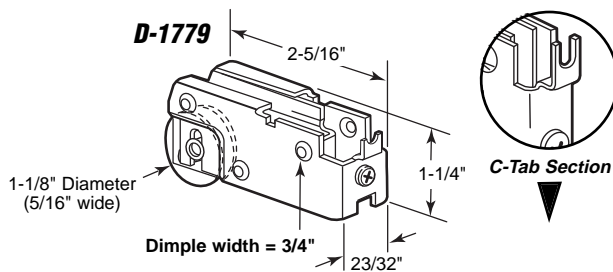

## D-1779

### Roller Assembly

**Contents:** 1 roller assembly.

**Description:** Steel ball bearing roller; adjustable steel housing assembly; overall thickness 3/4" fits on *Merzon Aluminum Products*.

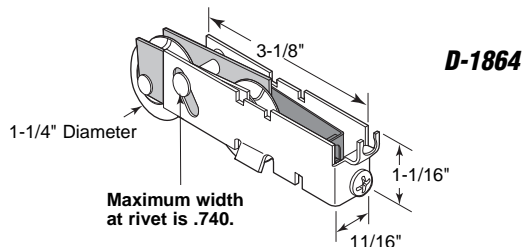

## D-1864

### Tandem Roller Assembly

**Contents:** 1 roller assembly.

**Description:** Tandem steel ball bearing roller; adjustable steel housing assembly; maximum width at rivet is .740.

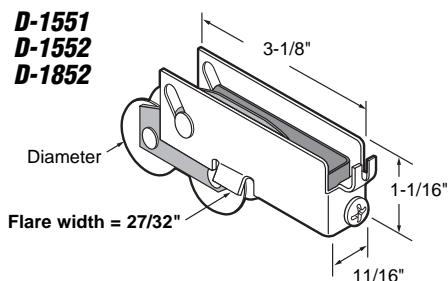

**D-1551** (1-1/8" Steel )

**D-1552** (1-1/4" Steel )

**D-1852** (1-1/4" Nylon)

### Tandem Roller Assembly

**Contents:** 1 roller assembly.

**Description:** Tandem ball bearing rollers; adjustable steel housing assembly; fits on *Pacific* and other patio door manufacturers.

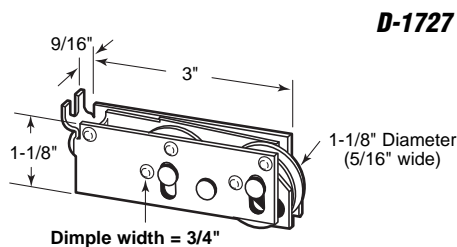

## D-1727

### Tandem Roller Assembly

**Contents:** 1 roller assembly.

**Description:** Tandem steel ball bearing rollers; adjustable steel housing assembly.

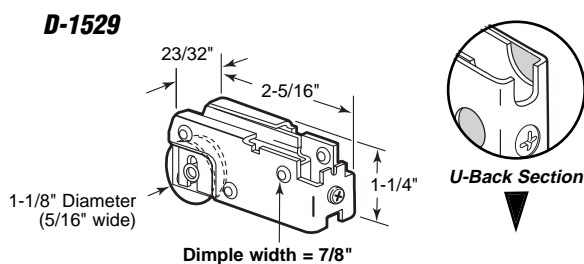

## D-1529

### Roller Assembly

**Contents:** 1 roller assembly.

**Description:** Steel ball bearing roller; adjustable steel housing assembly; fits on *Northrop*.

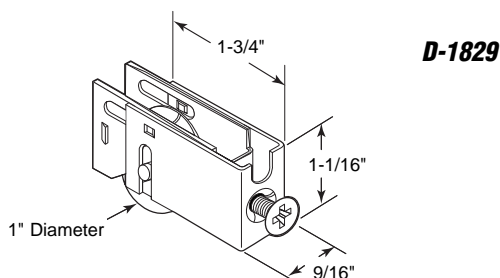

## D-1829

### Roller Assembly

**Contents:** 1 roller assembly.

**Description:** Steel ball bearing roller; adjustable steel housing assembly;

## D-1818

### Roller Assembly

**Contents:** 1 roller assembly.

**Description:** 1" x 1/4" flat steel ball bearing roller assembly; adjustable steel housing.

## D-1771

### Roller Assembly

**Contents:** 1 roller assembly.

**Description:** Nylon ball bearing roller; adjustable steel housing; fits on "Patio Enclosures".

## D-1755

### Roller Assembly

**Contents:** 1 roller assembly.

**Description:** Steel ball bearing roller; adjustable steel housing assembly; used by several patio door manufacturers.

## D-1758

### Roller Assembly

**Contents:** 1 roller assembly.

**Description:** Steel ball bearing roller; adjustable steel housing assembly; fits on *Better-Bilt* and other manufacturers.

## D-1768 (1-1/4" Steel)

## D-1872 (1-1/2" Steel)

## D-1871 (1-1/4" Nylon)

## D-1873 (1-1/2" Nylon)

### Roller Assembly

**Contents:** 1 roller assembly.

**Description:** Ball bearing roller; adjustable steel housing assembly; fits on *Better-Bilt* and other patio door manufacturers.

## D-1774

### Roller Assembly

**Contents:** 1 roller assembly.

**Description:** 1" flat steel ball bearing roller; adjustable steel housing assembly; fits on *Capitol Door*.



**D-1818**

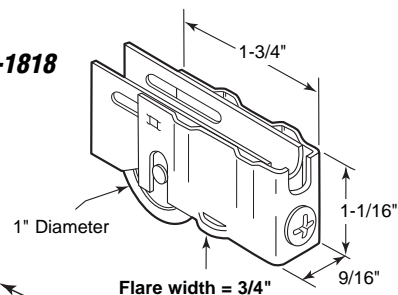

**D-1771**

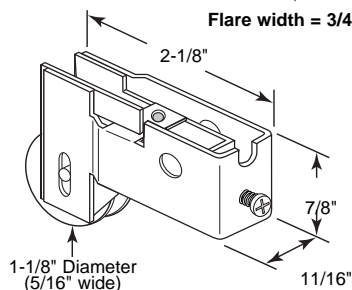

**D-1755**

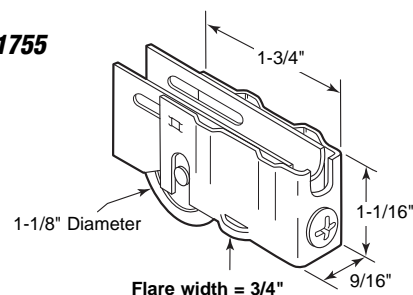

**D-1758**

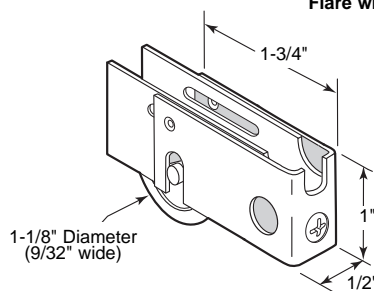

**D-1768**

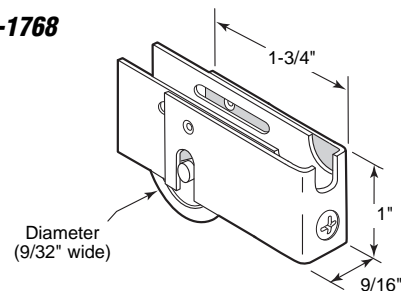

**D-1774**

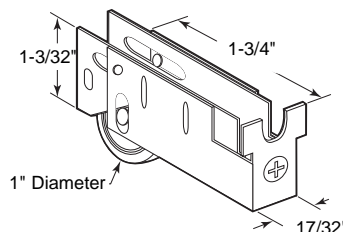

## D-1781

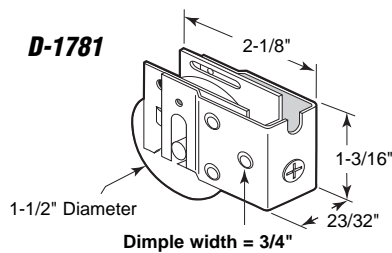

U-Back Section

## D-1781

### Roller Assembly

**Contents:** 1 roller assembly.

**Description:** Steel ball bearing roller; adjustable steel housing assembly; fits on *Lausell Aluminum* and other patio door manufacturers.

## D-1782

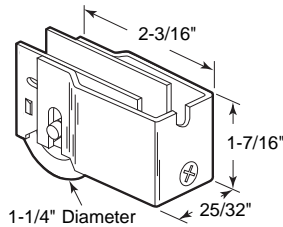

## D-1782

### Roller Assembly

**Contents:** 1 roller assembly.

**Description:** Steel ball bearing roller; adjustable steel housing assembly; fits on *Crown Manufacturing* and *Penco*.

## D-1777 D-1778

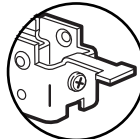
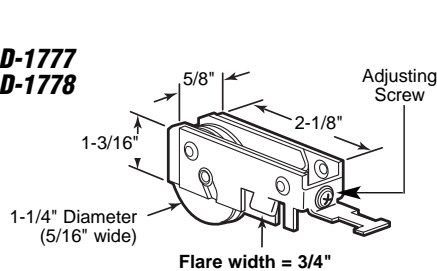

K-Tab Section

**D-1777** (Nylon)

**D-1778** (Stainless steel)

### Roller Assembly

**Contents:** 1 roller assembly.

**Description:** Ball bearing roller; adjustable aluminum housing assembly to resist corrosion; fits on *International* and other patio door manufacturers.

## D-1525 D-1789

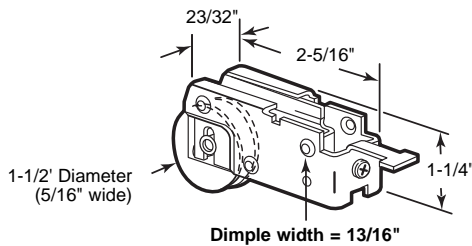

**D-1525** (Steel)

**D-1789** (Nylon)

### Roller Assembly

**Contents:** 1 roller assembly.

**Description:** Ball bearing roller; adjustable steel housing assembly; fits on *Marshall* and other patio door manufacturers.

## D-1523 D-1728 D-1837

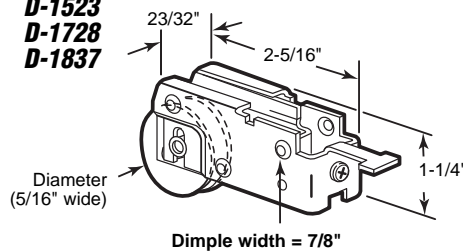

**D-1523** (1-1/8" Steel)

**D-1728** (1-1/4" Nylon)

**D-1837** (1" Steel)

### Roller Assembly

**Contents:** 1 roller assembly.

**Description:** Ball bearing roller; adjustable steel housing assembly; used by several patio door manufacturers.

## D-1516

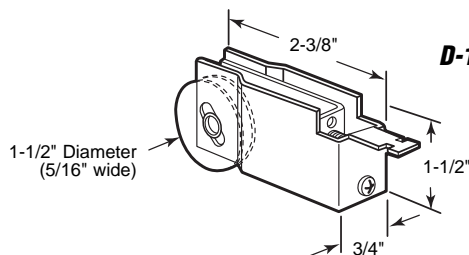

## D-1516

### Roller Assembly

**Contents:** 1 roller assembly.

**Description:** Nylon ball bearing roller; adjustable steel housing assembly; fits on *Doormaster* and other patio door manufacturers.

# Sliding Patio Door

**D-1518** (Steel)  
**D-1720** (Nylon)

## Roller Assembly

**Contents:** 1 roller assembly.

**Description:** Ball bearing roller; adjustable steel housing; fits on *International* and other patio door manufacturers.

**D-1524**

## Roller Assembly

**Contents:** 1 roller assembly.

**Description:** Steel ball bearing roller; adjustable steel housing assembly; fits on *T.M Cobb* and other patio door manufacturers.

**D-1788**

## Roller Assembly

**Contents:** 1 roller assembly.

**Description:** Steel ball bearing roller; adjustable steel housing; used by several patio door manufacturers.

**D-1512**

## Roller Assembly

**Contents:** 1 roller assembly.

**Description:** Nylon ball bearing roller; adjustable steel housing assembly; used by several patio door manufacturers.

**D-1513**

## Roller Assembly

**Contents:** 1 roller assembly.

**Description:** Nylon ball bearing roller; adjustable steel housing assembly; fits on *Rebco-West* doors.

**D-1696** (1-1/8" Steel)  
**D-1841** (1-1/2" Steel)

## Roller Assembly

**Contents:** 1 roller assembly.

**Description:** Steel ball bearing roller; adjustable steel housing.

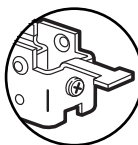

K-Tab Section

**D-1518**  
**D-1720**

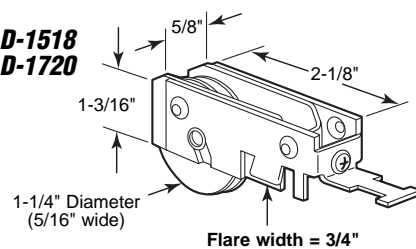

Flare width = 3/4"

**D-1524**

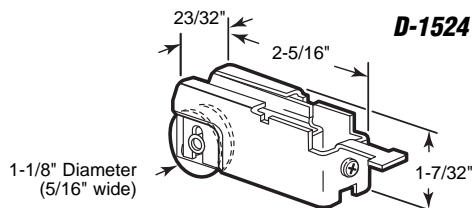

**D-1788**

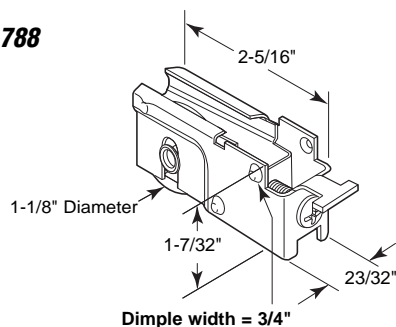

Dimple width = 3/4"

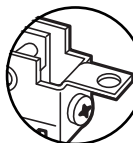

B-Tab Section

**D-1512**

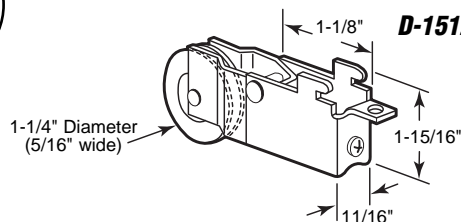

**D-1513**

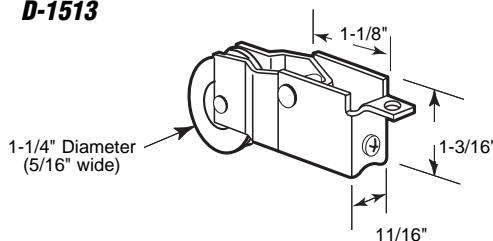

**D-1696**  
**D-1841**

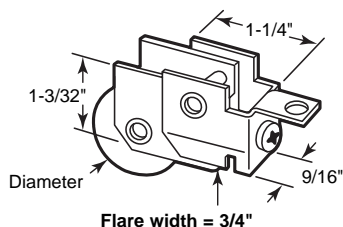

Flare width = 3/4"

## D-1697 D-1698

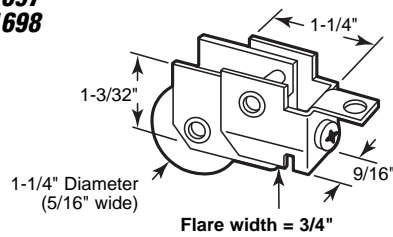

**D-1697** (Steel)  
**D-1698** (Nylon)

### Roller Assembly

**Contents:** 1 roller assembly.

**Description:** Ball bearing roller; adjustable steel housing assembly.

## D-1812

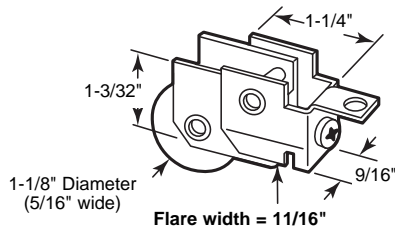

## D-1812

### Roller Assembly

**Contents:** 1 roller assembly.

**Description:** Nylon ball bearing roller; adjustable steel housing assembly; used by many mirror and wardrobe manufacturers.

## D-1775

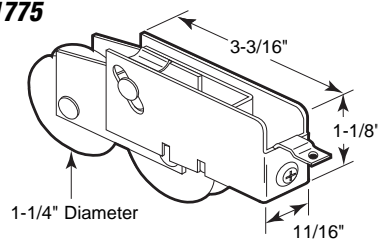

## D-1775

### Tandem Roller Assembly

**Contents:** 1 roller assembly.

**Description:** Tandem steel ball bearing rollers; adjustable steel housing assembly; fits on *Louisiana-Pacific Corp.* and other patio door manufacturers.

## D-1819

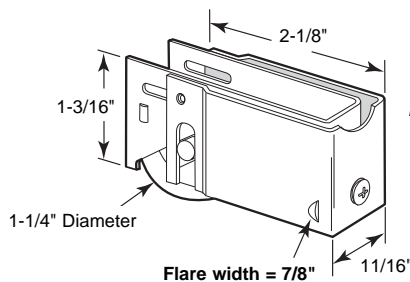

## D-1819

### Roller Assembly

**Contents:** 1 roller assembly.

**Description:** Steel ball bearing roller; adjustable steel housing assembly.

## D-1831 D-1832 D-1833 D-1834

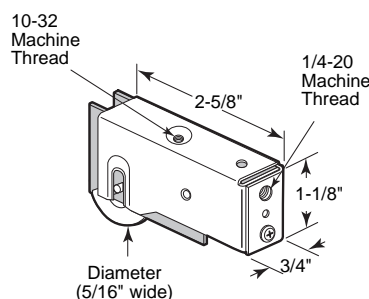

**D-1831** (1-1/2" Steel)  
**D-1832** (1-1/4" Steel)  
**D-1833** (1-1/2" Nylon)  
**D-1834** (1-1/4" Nylon)

### Roller Assembly

**Contents:** 1 roller assembly.

**Description:** Ball bearing roller; adjustable steel housing assembly; used by many patio door manufacturers.

## D-1542

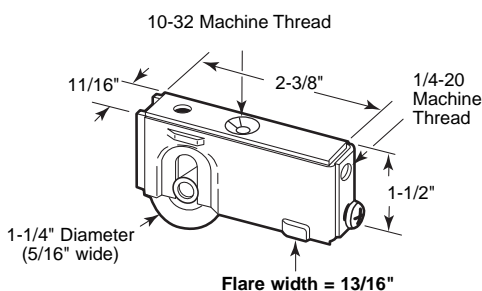

## D-1542

### Roller Assembly

**Contents:** 1 roller assembly.

**Description:** Steel ball bearing roller; adjustable steel housing assembly; used by several manufacturers.



## D-1750

### Roller Assembly

**Contents:** 1 roller assembly.

**Description:** Steel ball bearing roller; adjustable steel housing assembly; used by several manufacturers.

**D-1537** (1-1/2" Steel)

**D-1747** (1-1/4" Steel)

**D-1748** (1-1/8" Steel)

**D-1849** (1-1/4" Nylon)

### Roller Assembly

**Contents:** 1 roller assembly.

**Description:** Ball bearing roller; adjustable steel housing assembly; fits on *Fleetwood* and other patio door manufacturers.

## D-1538

### Roller Assembly

**Contents:** 1 roller assembly.

**Description:** Steel ball bearing roller; adjustable steel housing assembly; fits on *Fleetwood*, *Blomberg* and other manufacturers.

## D-1592

### Roller Assembly

**Contents:** 1 roller assembly.

**Description:** Steel ball bearing roller; adjustable steel housing assembly; fits on *Daryl*, *Patio Magic* and other patio door manufacturers.

## D-1860

### Roller Assembly

**Contents:** 1 roller assembly.

**Description:** Steel ball bearing roller; adjustable steel housing assembly; fits on *Keller* and other patio door manufacturers.

## D-1541

### Roller Assembly

**Contents:** 1 roller assembly.

**Description:** Steel ball bearing roller; adjustable steel housing assembly; fits on *Blomberg* and other patio door manufacturers.

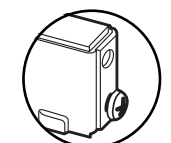

Plain Back Section

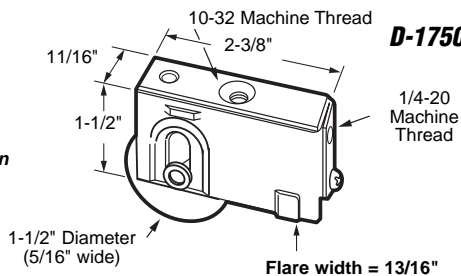

**D-1750**

**D-1537  
D-1747  
D-1748  
D-1849**

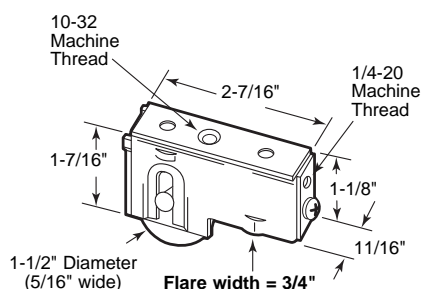
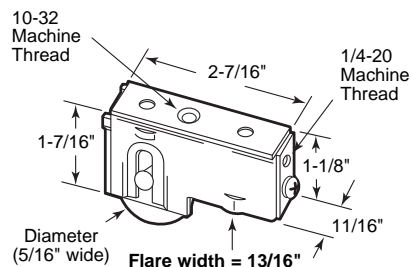

**D-1538**

**D-1592**

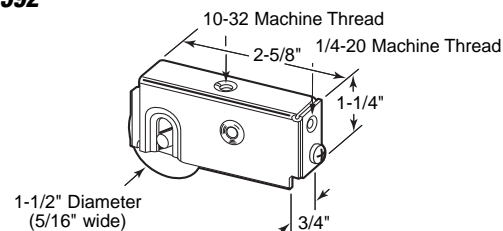

**D-1860**

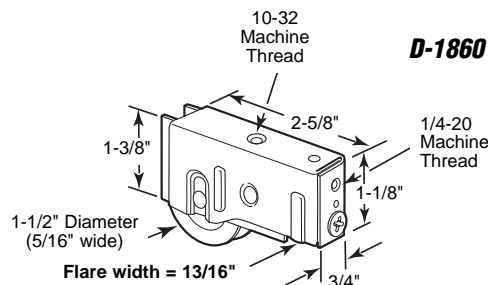

**D-1541**

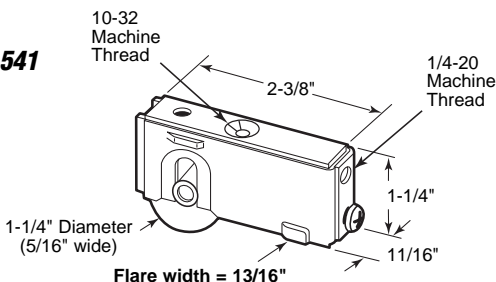



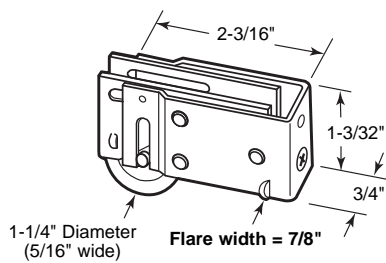

**D-1707**

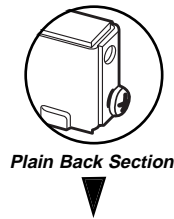

**D-1723**  
**D-1724**

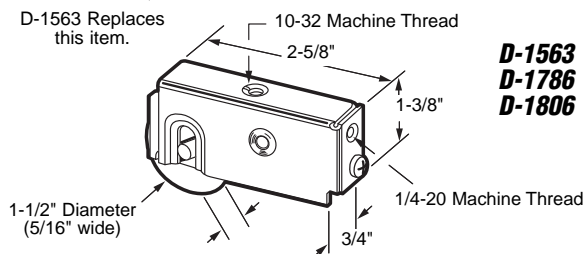
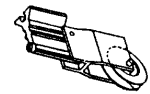
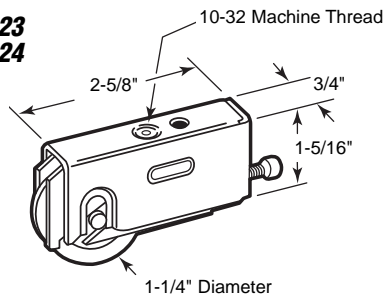

**D-1563**  
**D-1786**  
**D-1806**

**D-1597**

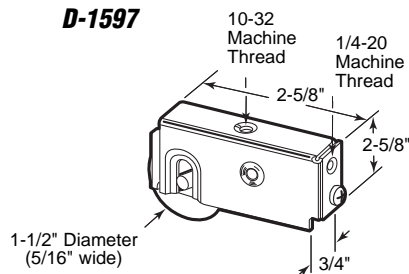

**D-1770**

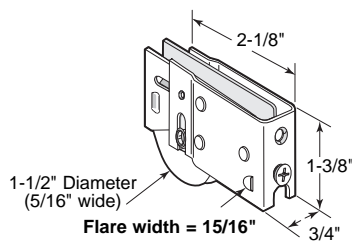

## D-1707

### Roller Assembly

**Contents:** 1 roller assembly.

**Description:** Steel ball bearing roller; adjustable steel housing assembly; used by several patio door manufacturers.

You may also wish to stock these related parts: **D-1592** and **1593**.

## D-1723 (Steel)

## D-1724 (Nylon)

### Roller Assembly

**Contents:** 1 roller assembly.

**Description:** Ball bearing roller; adjustable steel housing. Used by many patio door manufacturers.

## D-1563 (Steel)

## D-1786 (Nylon)

## D-1806 (Stainless steel roller and housing)

### Roller Assembly

**Contents:** 1 roller assembly.

**Description:** Ball bearing roller; adjustable steel housing assembly; fits on *Air Control*, *Howmet*, *Krestmark*, and many other patio door manufacturers. Stainless steel used in severe weather conditions.

## D-1597 (Nylon)

### Roller Assembly

**Contents:** 1 roller assembly.

**Description:** Ball bearing roller; adjustable steel housing assembly; fits on *Lenahan* and other manufacturers.

## D-1770

### Roller Assembly

**Contents:** 1 roller assembly.

**Description:** Steel ball bearing roller; adjustable steel housing; fits on *Harcar*, *Bee Cee* and other patio door manufacturers.

## D-1759

### Roller Assembly

**Contents:** 1 roller assembly.

**Description:** Steel ball bearing roller; adjustable steel housing assembly; fits on **Keller Windows** and other patio door manufacturers.

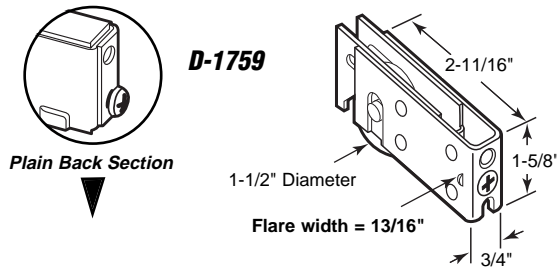

## D-1688

### Roller Assembly

**Contents:** 1 roller assembly.

**Description:** Steel ball bearing roller; adjustable steel housing assembly; fits on **Nu-Air, Bennings, Scotty** and many other patio door manufacturers.

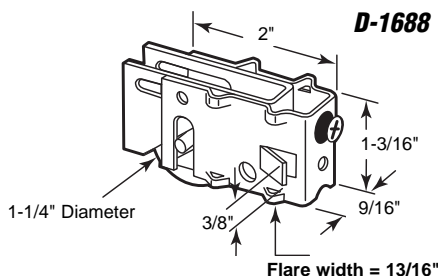

## D-1763

### Roller Assembly

**Contents:** 1 roller assembly.

**Description:** Steel ball bearing roller; adjustable steel housing; fits on **Pan Am** and other patio door manufacturers.

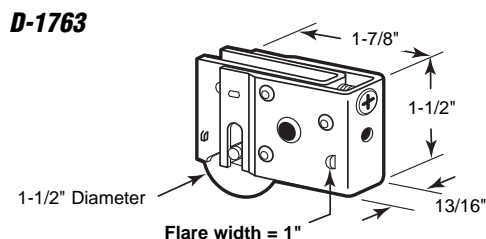

## D-1708

### Roller Assembly

**Contents:** 1 roller assembly.

**Description:** Steel ball bearing roller; adjustable steel housing assembly; fits on **Harcar, Bee Cee** and other patio door manufacturers.

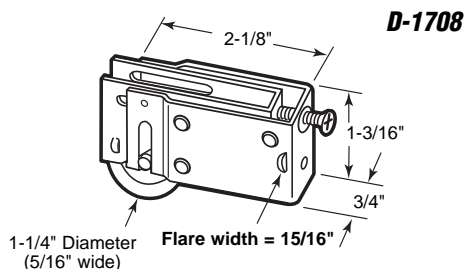

## D-1820

### Roller Assembly

**Contents:** 1 roller assembly.

**Description:** Steel ball bearing roller; adjustable steel housing assembly.

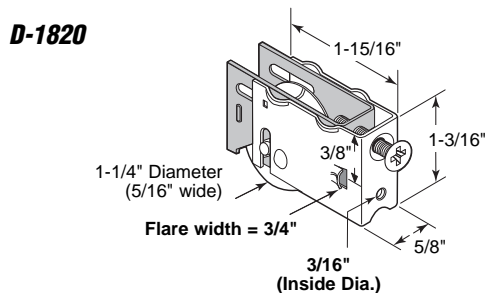

## D-1821

### Roller Assembly

**Contents:** 1 roller assembly.

**Description:** Steel bearing roller; adjustable steel housing assembly.

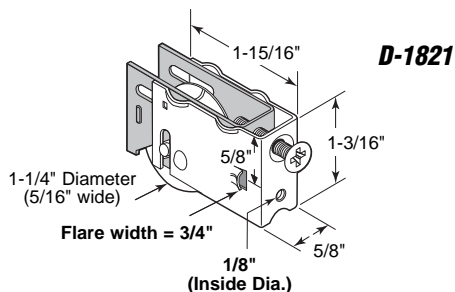

## D-1822

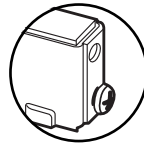
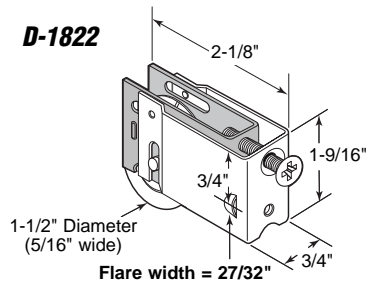

Plain Back Section

## D-1823

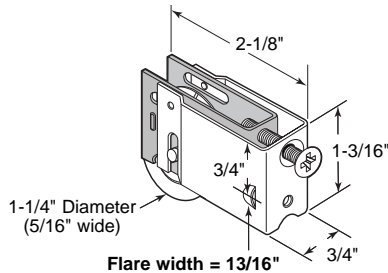

## D-1827

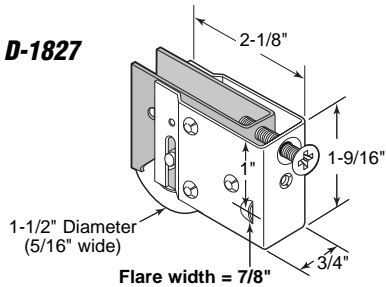

## D-1835

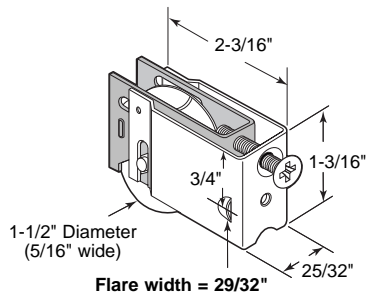

## D-1824

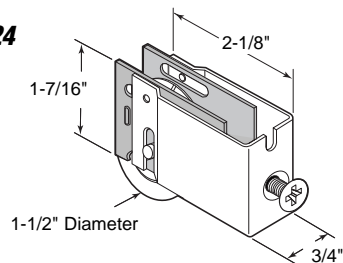

## D-1828

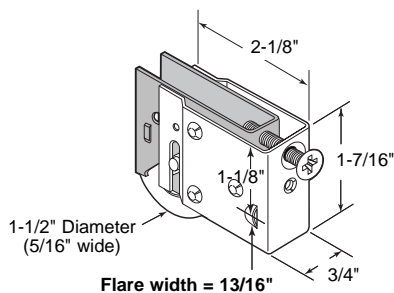

## D-1822

### Roller Assembly

**Contents:** 1 roller assembly.

**Description:** Steel ball bearing roller; adjustable steel housing assembly.

## D-1823

### Roller Assembly

**Contents:** 1 roller assembly.

**Description:** Steel ball bearing roller; adjustable steel housing assembly.

## D-1827

### Roller Assembly

**Contents:** 1 roller assembly.

**Description:** Steel ball bearing roller; adjustable steel housing assembly.

## D-1835

### Roller Assembly

**Contents:** 1 roller assembly.

**Description:** Steel ball bearing roller; adjustable steel housing assembly.

## D-1824

### Roller Assembly

**Contents:** 1 roller assembly.

**Description:** Steel ball bearing roller; adjustable steel housing assembly.

## D-1828

### Roller Assembly

**Contents:** 1 roller assembly.

**Description:** Steel ball bearing roller; adjustable steel housing assembly.

# Sliding Patio Door

## D-1761

### Roller Assembly

**Contents:** 1 roller assembly.

**Description:** Steel ball bearing roller; adjustable steel housing assembly; fits on *Crown Windows* and other patio door manufacturers.

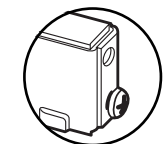

Plain Back Section

## D-1761

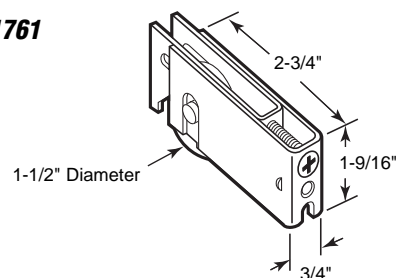

## D-1762

### Roller Assembly

**Contents:** 1 roller assembly.

**Description:** Steel ball bearing roller; adjustable steel housing; fits on *Nu-Air* and other patio door manufacturers.

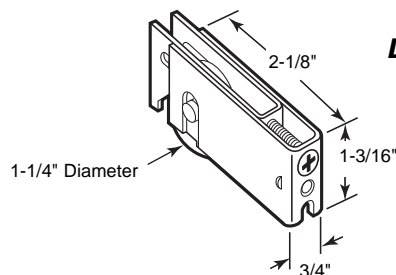

## D-1762

## D-1600

### Roller Assembly

**Contents:** 1 roller assembly.

**Description:** Steel ball bearing roller; adjustable steel housing assembly; fits on *Harcar* and other patio door manufacturers.

## D-1600

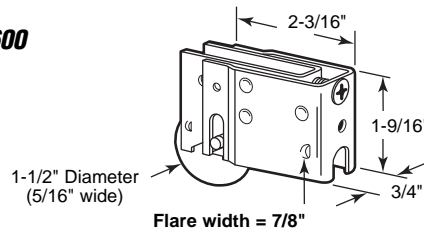

## D-1757

### Roller Assembly

**Contents:** 1 roller assembly.

**Description:** 1" flat steel ball bearing roller; adjustable steel housing assembly; fits on *Capitol Door*.

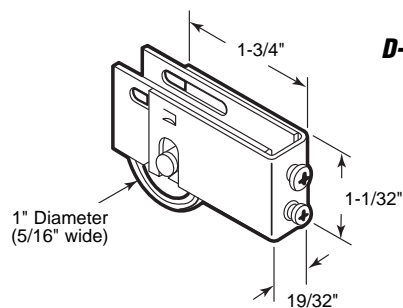

## D-1757

## D-1751

### Roller Assembly

**Contents:** 1 roller assembly.

**Description:** Steel ball bearing roller; adjustable steel housing assembly; used by several patio door manufacturers.

## D-1751

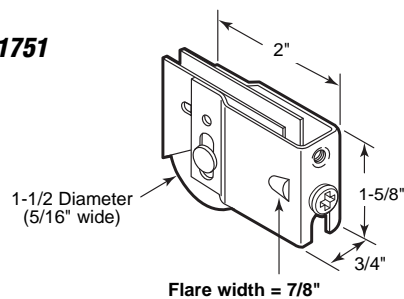

## D-1830

### Roller Assembly

**Contents:** 1 roller assembly.

**Description:** Steel ball bearing roller; adjustable steel housing assembly.

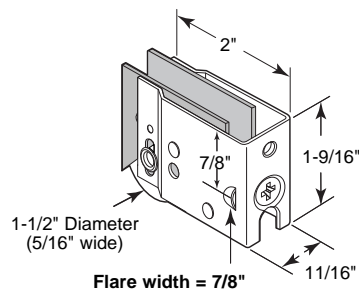

## D-1830

## D-1596

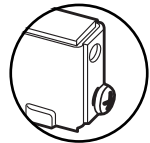
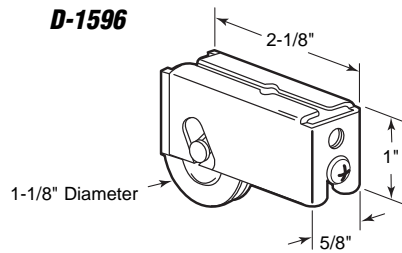

Plain Back Section

## D-1596

### Roller Assembly

**Contents:** 1 roller assembly.

**Description:** Steel ball bearing roller; adjustable steel housing assembly; fits on *Capitol Mfg.*

## D-1536

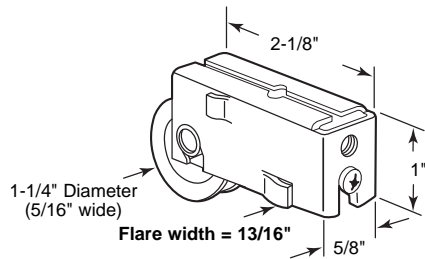

## D-1536

### Roller Assembly

**Contents:** 1 roller assembly.

**Description:** Nylon ball bearing roller; adjustable steel housing assembly; fits on *Regal* and other patio door manufacturers.

## D-1535 D-1785 D-1848

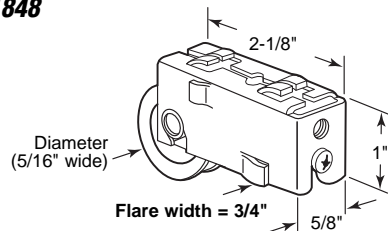

## D-1535 (1-1/4" Nylon) D-1785 (1-1/4" Steel) D-1848 (1-1/8" Steel)

### Roller Assembly

**Contents:** 1 roller assembly.

**Description:** Ball bearing roller; adjustable steel housing assembly; fits on *Smith Carry* and other patio door manufacturers.

## D-1557 D-1726

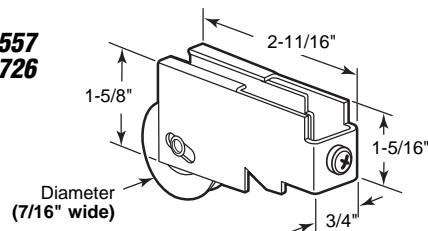

## D-1557 (1-11/16" Nylon) D-1726 (1-13/16" Steel)

### Roller Assembly

**Contents:** 1 roller assembly.

**Description:** Ball bearing roller; steel housing assembly; fits on *Arcadia* and other patio door manufacturers.

## D-1731 D-1793

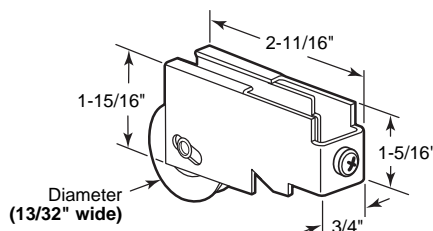

## D-1731 (1-11/16" Nylon) D-1793 (1-13/16" Steel)

### Roller Assembly

**Contents:** 1 roller assembly.

**Description:** Ball bearing roller; adjustable steel housing assembly; fits on *Arcadia* and other patio door manufacturers.

# Sliding Patio Door

## D-1554

### Roller Assembly

**Contents:** 1 roller assembly.

**Description:** Steel ball bearing roller; adjustable steel housing assembly; fits on **Acorn Door** and other patio door manufacturers.

## D-1807

### Roller Assembly

**Contents:** 1 roller assembly.

**Description:** Steel ball bearing roller; adjustable steel housing assembly.

## D-1850

### Roller Assembly

**Contents:** 1 roller assembly.

**Description:** Steel ball bearing roller; adjustable extruded aluminum housing assembly; fits on **Daryl** and other patio door manufacturers.

## D-1534 (Steel)

## D-1805 (Nylon)

### Roller Assembly

**Contents:** 1 roller assembly.

**Description:** Ball bearing roller; adjustable steel housing assembly; fits on **Overseas** and other patio door manufacturers.

## D-1608

### Roller Assembly

**Contents:** 1 roller assembly.

**Description:** Steel ball bearing roller; adjustable steel housing assembly; fits on several patio door manufacturers.

## D-1858

### Tandem Roller Assembly

**Contents:** 1 roller assembly.

**Description:** Tandem steel ball bearing roller; adjustable steel housing assembly; fits on **Keller** and other patio door manufacturers.

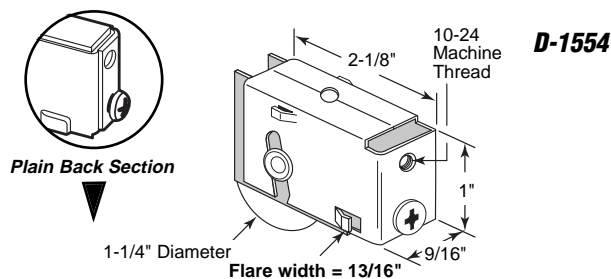

D-1807

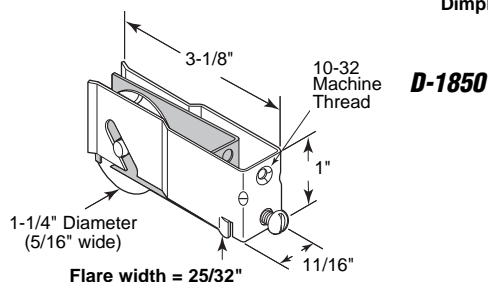
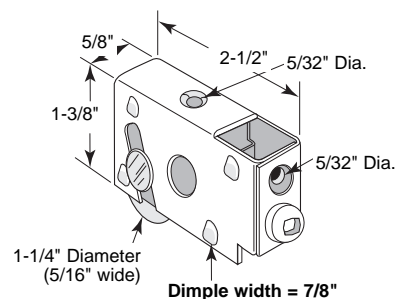

D-1534  
D-1805

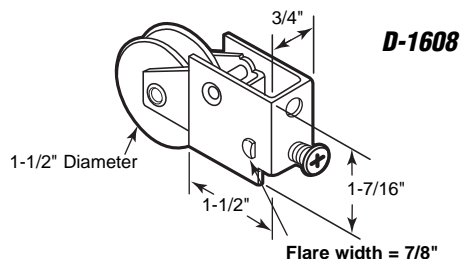
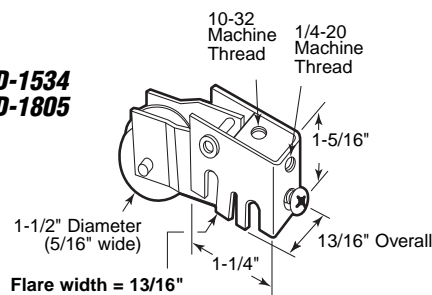

D-1858

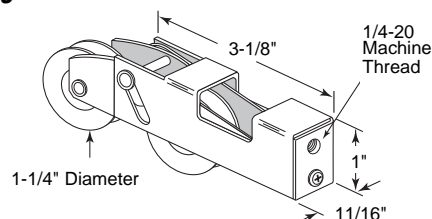

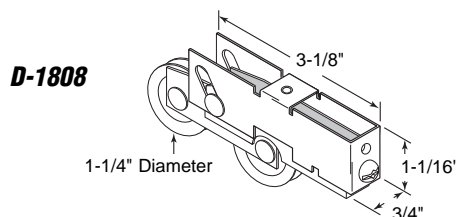
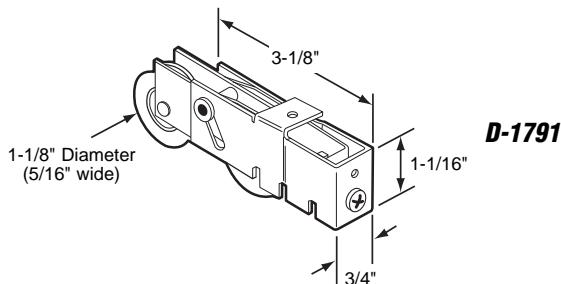
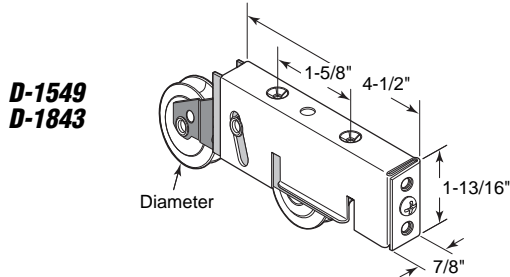
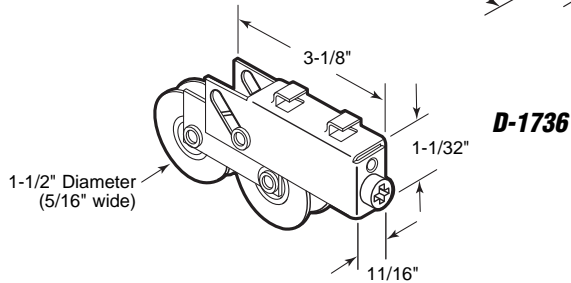
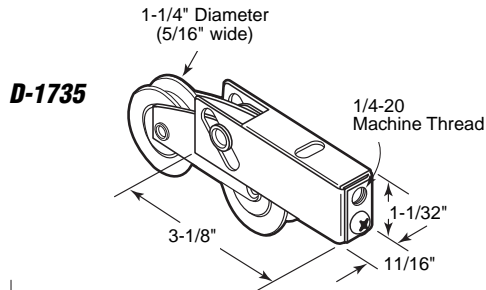
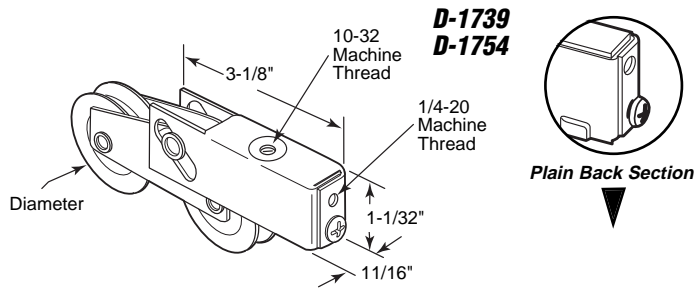

**D-1739** (1-1/4" Nylon)  
**D-1754** (1-1/2" Steel)

## Tandem Roller Assembly

**Contents:** 1 roller assembly.

**Description:** Tandem ball bearing rollers; adjustable steel housing assembly.

## D-1735

## Tandem Roller Assembly

**Contents:** 1 roller assembly.

**Description:** Tandem steel ball bearing rollers; adjustable steel housing.

## D-1736

## Tandem Roller Assembly

**Contents:** 1 roller assembly.

**Description:** Tandem steel ball bearing rollers; adjustable steel housing assembly fits on *Smith Carry Corp.*

**D-1549** (1-1/2" Steel B.B.)

**D-1843** (1-13/16" Steel B.B.)

## Tandem Roller Assembly

**Contents:** 1 roller assembly.

**Description:** Tandem steel ball bearing rollers; adjustable steel housing assembly; fits on *Armour Vue, Disco, Atlas* and many other patio door manufacturers.

## D-1791

## Tandem Roller Assembly

**Contents:** 1 roller assembly.

**Description:** Tandem steel ball bearing rollers; adjustable steel housing assembly.

## D-1808

## Tandem Roller Assembly

**Contents:** 1 roller assembly.

**Description:** Tandem steel ball bearing roller; adjustable steel housing assembly.

## D-1689

### Tandem Roller Assembly

**Contents:** 1 roller assembly.

**Description:** Tandem steel ball bearing rollers; adjustable steel housing assembly; use by *Bee Cee* and other patio door manufacturers.

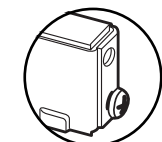

Plain Back Section

## D-1689

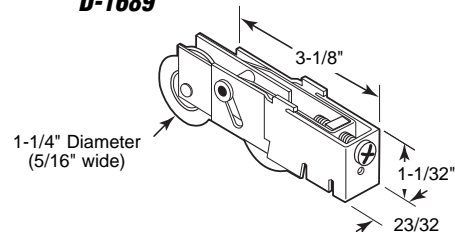

## D-1560

### Roller Assembly

**Contents:** 1 roller assembly.

**Description:** Steel ball bearing roller; adjustable steel housing assembly; fits on *Smith & Kelly* and other patio door manufacturers.



Unique Housing Section

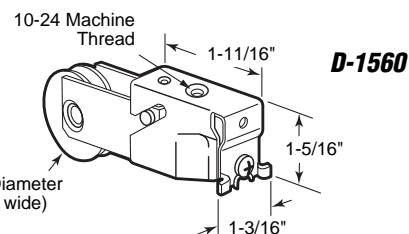

## D-1560

## D-1559

### Roller Assembly

**Contents:** 1 roller assembly.

**Description:** Steel ball bearing roller; adjustable steel housing assembly; fits on *Acorn*, *Wells Aluminum*, and other patio door manufacturers. Replaces old style diecast assembly.

## D-1559

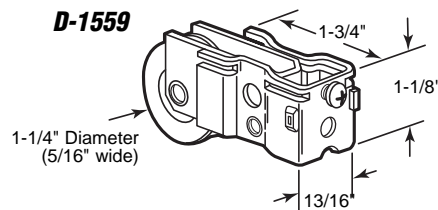

## D-1599

### Roller Assembly

**Contents:** 1 roller assembly.

**Description:** Nylon ball bearing roller; adjustable steel housing assembly; fits on *Marshall Aluminum* and other patio door manufacturers.

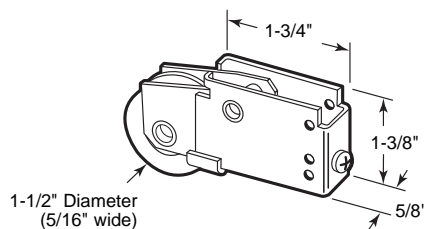

## D-1599

## D-1590

### Roller Assembly

**Contents:** 1 roller assembly.

**Description:** Steel ball bearing roller; adjustable steel housing assembly; fits on *Fullview*.

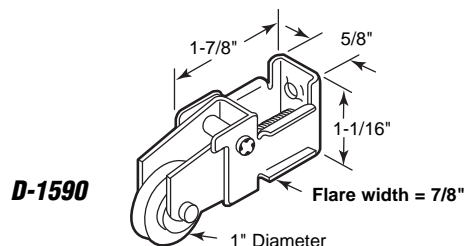

## D-1590



## D-1687

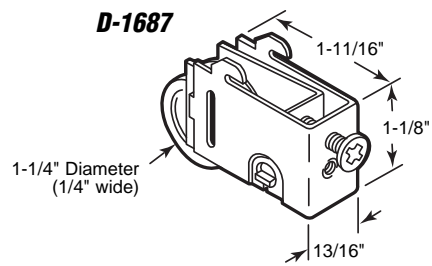

## D-1687

### Roller Assembly

**Contents:** 1 roller assembly.

**Description:** Steel ball bearing roller; adjustable steel housing assembly; fits on *Noranda Building Products*, *Three Rivers Aluminum* and *Bee Cee*.

## D-1556

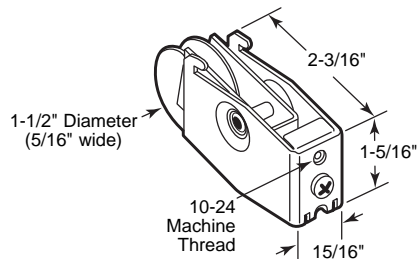

## D-1556

### Roller Assembly

**Contents:** 1 roller assembly.

**Description:** Nylon ball bearing roller; adjustable steel housing assembly; fits on *Northrop* and other patio door manufacturers.

## D-1561 D-1562

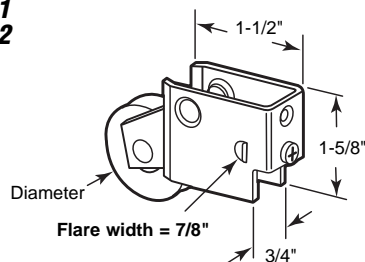

## D-1561 (1-1/4")

## D-1562 (1-1/2")

### Roller Assembly

**Contents:** 1 roller assembly.

**Description:** Steel ball bearing roller; adjustable zinc plated steel housing assembly; fits on *Keller* and other patio door manufacturers.

## D-1601

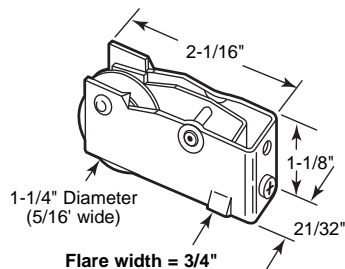

## D-1601

### Roller Assembly

**Contents:** 1 roller assembly.

**Description:** Steel ball bearing roller; adjustable steel housing assembly; fits on *Crossly* and other patio door manufacturers.

## D-1794

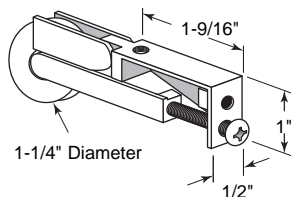

## D-1794

### Roller Assembly

**Contents:** 1 roller assembly.

**Description:** Steel ball bearing roller; adjustable diecast housing assembly; used by many patio door manufacturers.

## D-1734

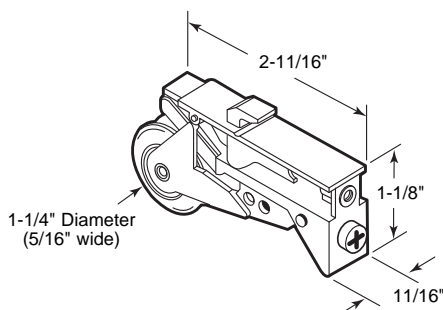

## D-1734

### Roller Assembly

**Contents:** 1 roller assembly.

**Description:** Steel ball bearing roller; adjustable diecast housing assembly; used by several patio door manufacturers.

# Sliding Patio Door

**D-1533** (Steel)

**D-1621** (Nylon)

## Roller Assembly

**Contents:** 1 roller assembly.

**Description:** Ball bearing roller; adjustable diecast housing assembly; fits on *Fleetwood*, *Fullview* and many other patio door manufacturers.

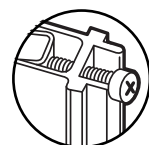

Unique Housing Section

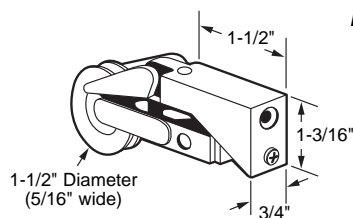

**D-1533**

**D-1621**

**D-1640**

## Roller Assembly

**Contents:** 1 roller assembly.

**Description:** Steel ball bearing roller; adjustable diecast housing assembly; used by many patio door manufacturers.

**D-1640**

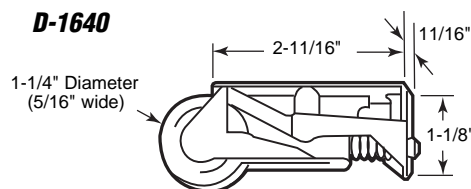

**D-1587** (1-1/4" Nylon)

**D-1810** (1-1/2" Nylon)

**D-1825** (1-1/2" Steel)

## Roller Assembly

**Contents:** 1 roller assembly.

**Description:** Ball bearing roller; adjustable diecast housing assembly; fits on *Trimview* and many other manufacturers.

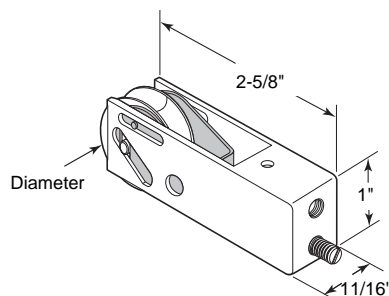

**D-1587**

**D-1810**

**D-1825**

**D-1532** (Steel)

**D-1620** (Nylon)

## Roller Assembly

**Contents:** 1 roller assembly.

**Description:** Ball bearing roller; adjustable diecast housing assembly; fits on *Fleetwood*, *Fullview* and many other patio door manufacturers.

**D-1532**  
**D-1620**

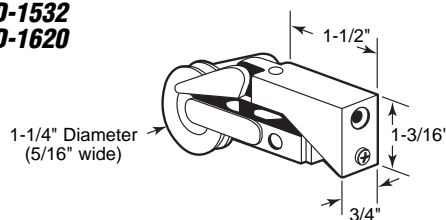

**D-1586** (Steel)

**D-1884** (Stainless steel)

## Tandem Roller Assembly

**Contents:** 1 roller assembly.

**Description:** Tandem ball bearing rollers; adjustable diecast housing assembly; fits on *Kawneer*.

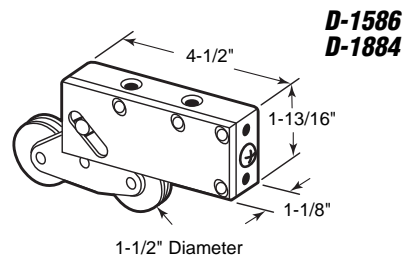

**D-1586**

**D-1884**

**D-1732**

## Roller Assembly

**Contents:** 1 roller assembly.

**Description:** Steel ball bearing roller; adjustable extruded aluminum housing assembly.

**D-1732**

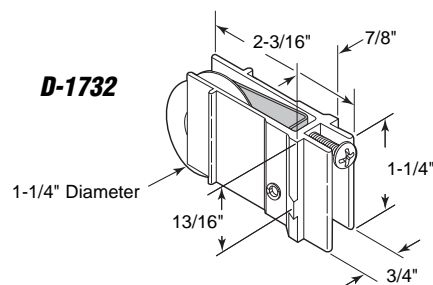

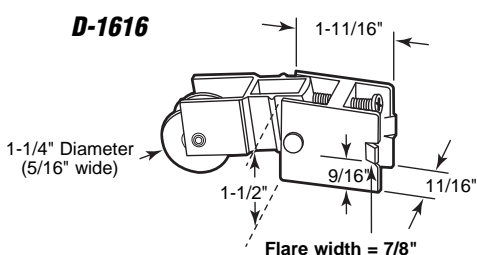
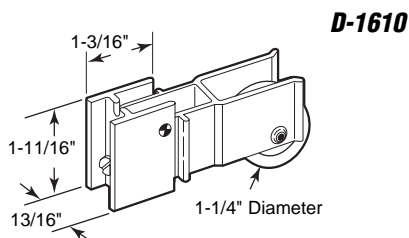
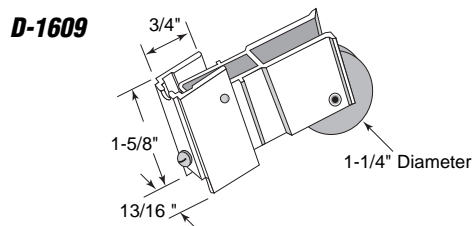
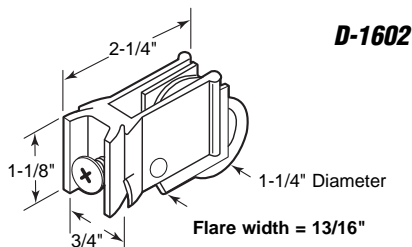
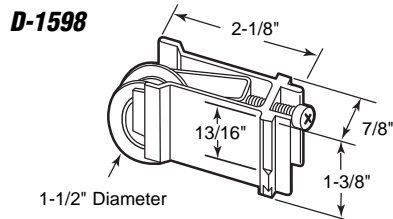
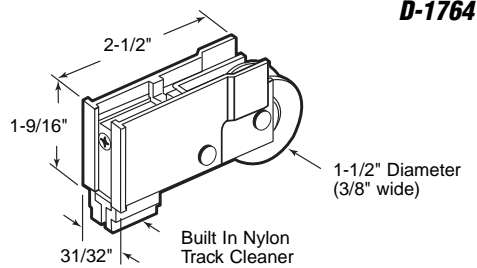

## D-1764

### Roller Assembly

**Contents:** 1 roller assembly.

**Description:** Nylon ball bearing roller; extruded aluminum housing assembly; nylon track cleaner; fits on *Alcan Door*.

## D-1598

### Roller Assembly

**Contents:** 1 roller assembly.

**Description:** Steel ball bearing roller; adjustable extruded aluminum housing assembly; fits on *Pan American, AAA Aluminum*; and other patio door manufacturers.

## D-1602

### Roller Assembly

**Contents:** 1 roller assembly.

**Description:** Steel ball bearing roller; adjustable extruded aluminum housing assembly; fits on *Miller Industries* and other patio door manufacturers.

## D-1609

### Roller Assembly

**Contents:** 1 roller assembly.

**Description:** Steel ball bearing roller; adjustable extruded aluminum housing assembly; fits on *Peachtree* and other patio door manufacturers.

## D-1610

### Roller Assembly

**Contents:** 1 roller assembly.

**Description:** Steel ball bearing roller; adjustable extruded aluminum housing assembly; fits on *Yoho, Payne, Peachtree*, and other patio door manufacturers.

## D-1616

### Roller Assembly

**Contents:** 1 roller assembly.

**Description:** Steel ball bearing roller; adjustable extruded aluminum housing assembly; fits on *Yoho* and other patio door manufacturers.

## D-1767

### Roller Assembly

**Contents:** 1 roller assembly.

**Description:** Steel ball bearing roller; adjustable extruded aluminum housing assembly; fits on several patio door manufacturers.



Unique Housing Section

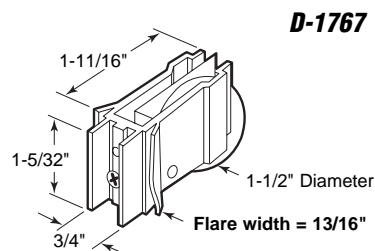

D-1767

## D-1863

### Roller Assembly

**Contents:** 1 roller assembly.

**Description:** Nylon ball bearing roller; adjustable extruded aluminum housing assembly.

D-1863

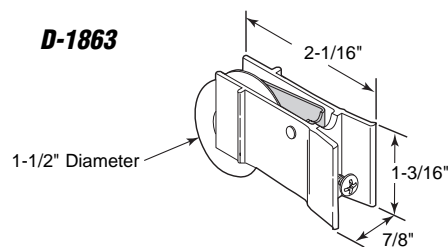

## D-1591

### Roller Assembly

**Contents:** 1 roller assembly.

**Description:** Nylon ball bearing roller; adjustable extruded aluminum housing assembly; fits on *Daryl*, *Plaza Door* and other patio door manufacturers.

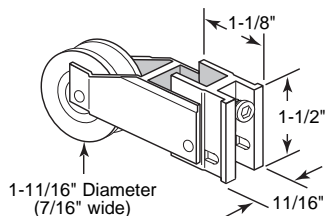

D-1591

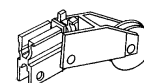

Old Style

## D-1683 (Nylon)

## D-1685 (Steel)

### Roller Assembly

**Contents:** 1 roller assembly.

**Description:** Ball bearing roller; adjustable steel housing; fits on *Ador Hilite* series 1200 patio doors.

D-1683  
D-1685

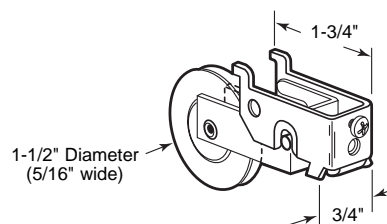

## D-1853

### Roller Assembly

**Contents:** 1 roller assembly.

**Description:** Steel ball bearing roller; adjustable steel housing assembly.

D-1853

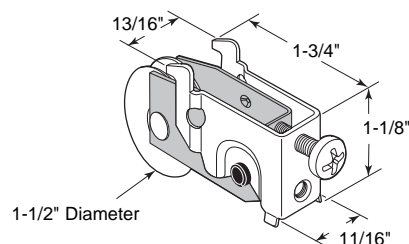

**D-1522**  
**D-1752**

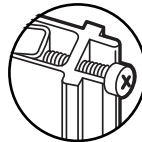
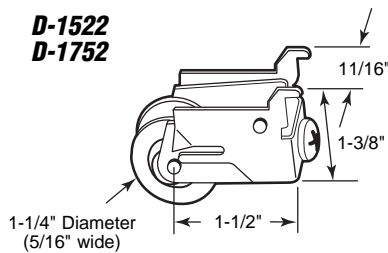

Unique Housing Section

**D-1715**

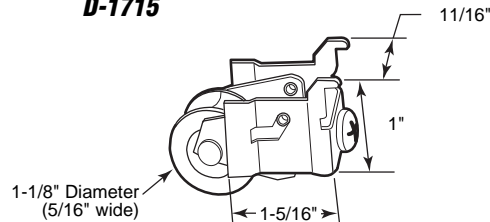

**D-1564**

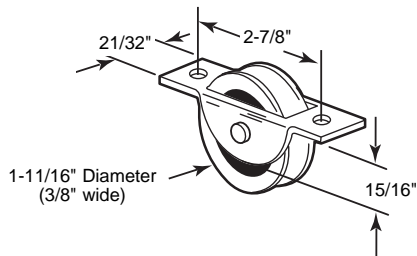

**D-1780**

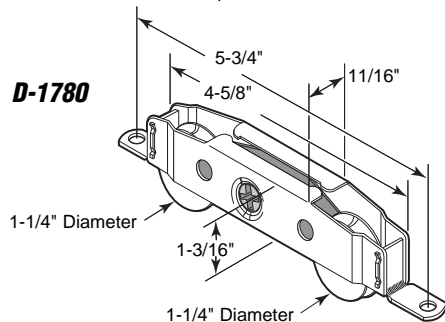

**D-1607**  
**D-1730**  
**D-1855**

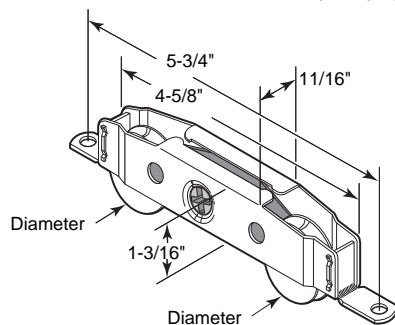

**D-1595**  
**D-1749**

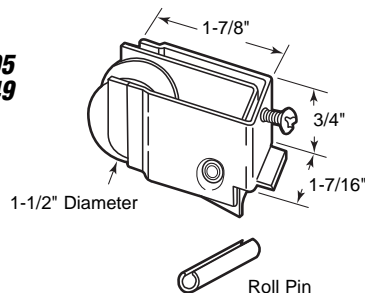

**D-1522** (Nylon)  
**D-1752** (Steel)

## Roller Assembly

**Contents:** 1 roller assembly.

**Description:** Ball bearing roller; adjustable steel housing assembly; fits on *Premier* and other patio door manufacturers.

**D-1715**

## Roller Assembly

**Contents:** 1 roller assembly.

**Description:** Steel ball bearing roller; adjustable steel housing assembly.

**D-1564**

## Roller Assembly

**Contents:** 1 roller assembly.

**Description:** Nylon ball bearing roller; aluminum housing; fits on *Western Patio* doors and other patio door manufacturers.

**D-1780**

## Tandem Roller Assembly (Stainless Steel)

**Contents:** 1 roller assembly.

**Description:** Tandem stainless steel ball bearing rollers; adjustable stainless steel housing assembly; used in severe weather environments.

**D-1607** (1-1/4" Steel)

**D-1730** (1-1/4" Nylon)

**D-1855** (1-1/2" Nylon)

## Tandem Roller Assembly

**Contents:** 1 roller assembly.

**Description:** Tandem ball bearing rollers; adjustable steel housing assembly.

**D-1595** (Nylon)

**D-1749** (Steel)

## Roller Assembly

**Contents:** 1 roller assembly.

**Description:** Ball bearing roller; adjustable steel housing assembly; fits on *Lumidor*, *C.E. Stanley* and other patio door manufacturers.

## D-1619

### Roller Assembly

**Contents:** 1 roller assembly.

**Description:** Steel ball bearing roller; adjustable steel housing assembly; fits on *Alwindor* and *Empire Pacific*.

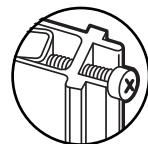

Unique Housing Section

## D-1619

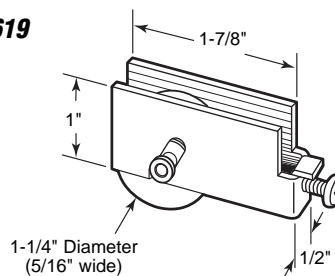

## D-1611 (1-1/4" Steel)

## D-1813 (1-1/8" Steel)

### Roller Assembly

**Contents:** 1 roller assembly.

**Description:** Ball bearing roller; adjustable steel housing assembly; fits on *Peachtree Door*.

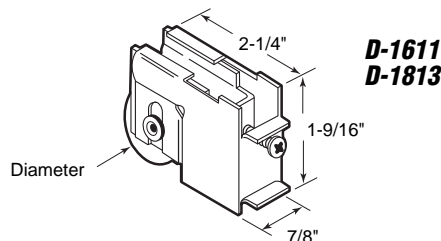

## D-1611 D-1813

## D-1547 (Nylon)

## D-1548 (Steel)

### Roller Assembly

**Contents:** 1 roller assembly.

**Description:** Dual ball bearing rollers; adjustable steel housing; fits on *Guaranteed Products* and other patio door manufacturers.

## D-1547 D-1548

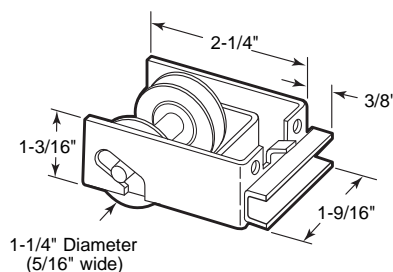

## D-1842

### Roller Assembly

**Contents:** 1 roller assembly.

**Description:** Steel ball bearing roller; adjustable diecast housing assembly; fits on "old style" *Acorn* doors.

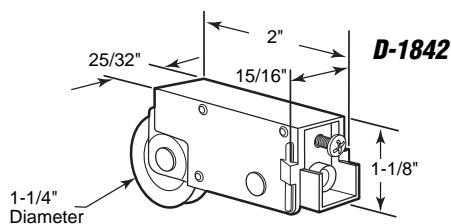

## D-1842

## D-1603

### Roller Assembly

**Contents:** 1 roller assembly.

**Description:** Steel ball bearing roller; adjustable diecast housing assembly; fits on *Crossly* and other patio door manufacturers.

## D-1603

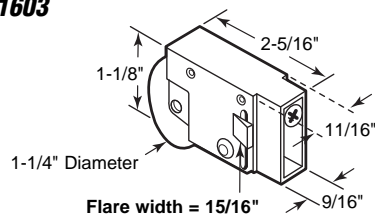

## D-1546 (Nylon)

## D-1585 (Steel)

### Roller Assembly

**Contents:** 1 roller assembly.

**Description:** Ball bearing roller in steel bracket; fits on *Adhor/ Hilight* and other patio door manufacturers. Use with D-1683 or D-1685 to replace inner roller assembly.

## D-1546 D-1585

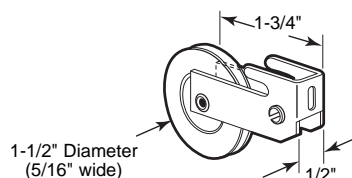

## D-1565

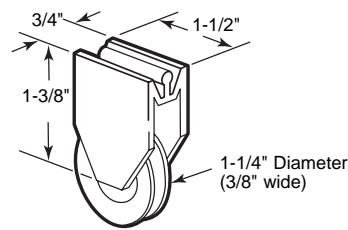

## D-1565

### Roller Assembly

**Contents:** 1 roller assembly.

**Description:** Nylon roller with bushing axle; non-adjustable nylon housing assembly; fits on *Likit* and other patio door manufacturers.

## D-1722

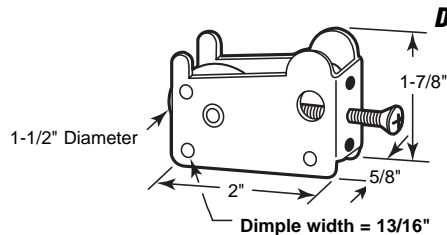

## D-1722

### Roller Assembly

**Contents:** 1 roller assembly.

**Description:** Steel ball bearing roller; galvanized steel housing.

## D-1544

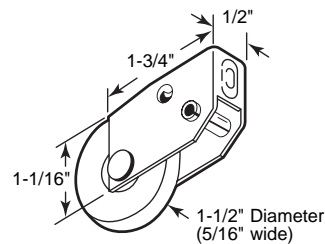

## D-1544

### Roller Assembly

**Contents:** 1 roller assembly.

**Description:** Steel ball bearing roller; steel bracket housing; fits on *H&D Industries* and several other patio door manufacturers.

## D-1721

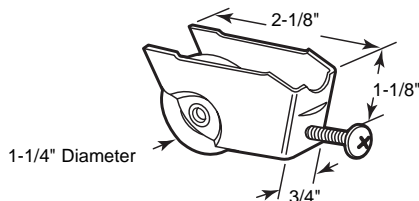

## D-1721

### Roller Assembly

**Contents:** 1 roller assembly.

**Description:** Steel ball bearing roller; steel housing.

## D-1836

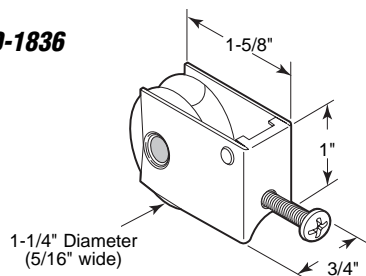

## D-1836

### Roller Assembly

**Contents:** 1 roller assembly.

**Description:** Steel ball bearing roller; stamped steel housing; Use with D-1560 to replace inner roller assembly.

## D-1637

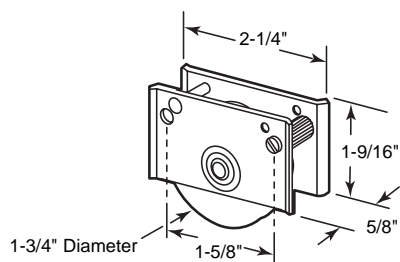

## D-1637

### Roller Assembly

**Contents:** 1 roller assembly.

**Description:** Steel ball bearing roller; steel housing (side plate on each side of bearing); steel gear with adjustment screws.



## D-1550

### Roller Assembly

**Contents:** 1 roller assembly.

**Description:** Nylon ball bearing roller; adjustable diecast housing assembly; fits on **Nudor** and other patio door manufacturers.

## D-1783 (Left hand)

## D-1784 (Right hand)

### Roller Assembly

**Contents:** 1 roller assembly.

**Description:** Nylon ball bearing roller; adjustable zinc diecast housing assembly.

## D-1555

### Door Roller Assembly

**Contents:** 1 roller assembly.

**Description:** Nylon ball bearing roller; adjustable diecast housing assembly; fits on **Art Door** and other patio door manufacturers.

## D-1617

### Roller Assembly

**Contents:** 1 roller assembly.

**Description:** Nylon ball bearing roller; adjustable steel inner housing; fits on **Capitol Door** products.

## D-1643

### Tandem Roller Assembly

**Contents:** 1 roller assembly.

**Description:** Nylon rollers with aluminum housing.

## D-1614

### Roller Assembly

**Contents:** 1 roller assembly.

**Description:** Flat nylon roller with brass bushing; adjustable diecast housing assembly.

## D-1613

### Roller Assembly

**Contents:** 1 roller assembly.

**Description:** Flat steel ball bearing roller; adjustable diecast housing assembly.

## D-1550

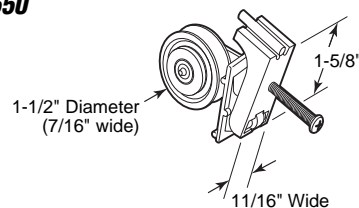

## D-1783 D-1784

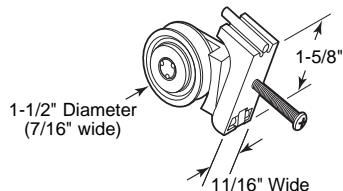

Right Hand Shown

## D-1555

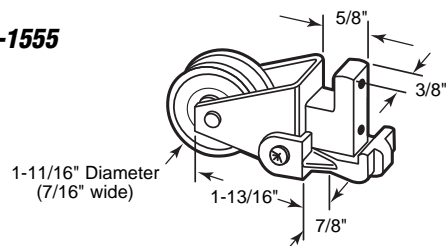

## D-1617

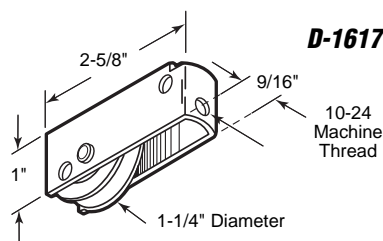

## D-1643

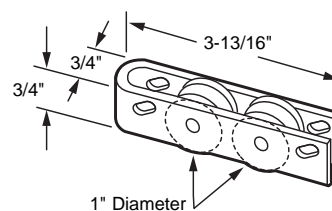

## D-1614

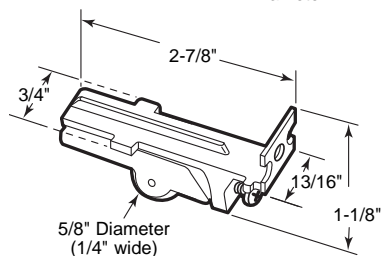

## D-1613

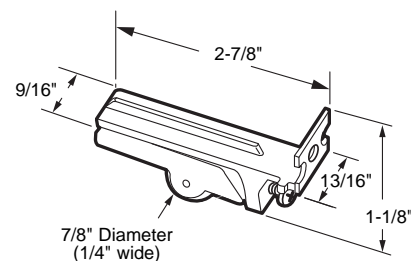



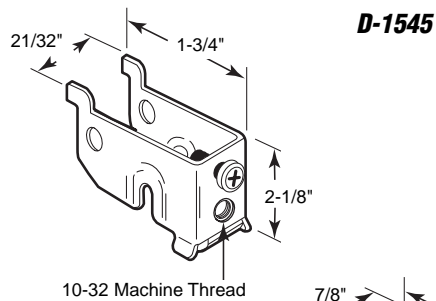

**D-1543**

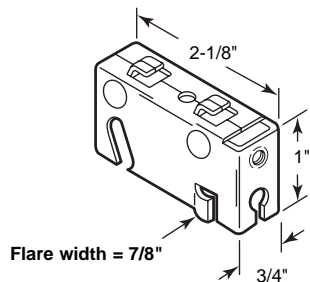
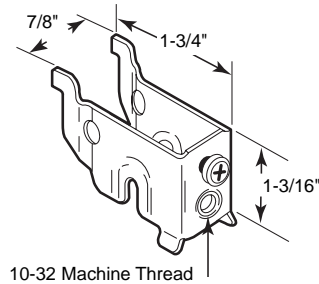

**D-1618**

**D-1566**

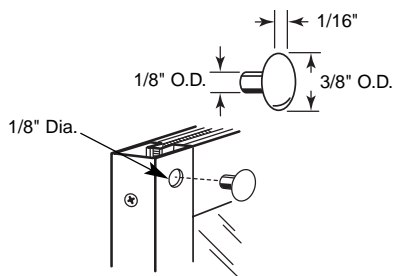
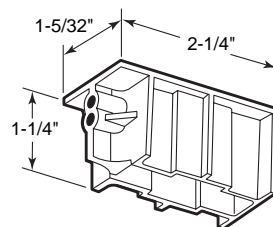

**D-1695**

**D-1570**

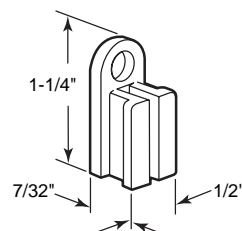

## D-1545

### Roller Housing

**Contents:** 1 roller housing assembly.

**Description:** Steel housing; fits on *Ador HiLite* to hold D-1546 and D-1585 roller assemblies.

## D-1543

### Roller Housing

**Contents:** 1 roller housing assembly.

**Description:** Steel housing; fits on *H&D Industries* and *Ador HiLite* to hold D-1544 roller assembly.

## D-1618

### Roller Housing

**Contents:** 1 roller housing assembly.

**Description:** Steel housing; fits on *Empire Pacific* and *Alwindor*.

## D-1566

### Roller Housing

**Contents:** 2 brackets.

**Description:** Nylon housing used to hold D-1567 roller assembly; fits on *Horizon* and other manufacturers.

## D-1695

### Guides

**Contents:** 12 guides.

**Description:** Nylon guides are used to prevent door rattle along the top rail.

## D-1570

### Guide

**Contents:** 4 guides.

**Description:** Nylon guides for top of doors; fits on *Fullview* and other manufacturers.

## D-1629

### Guides

**Contents:** 4 guides.

**Description:** Nylon guide; fits on *Daryl Industries*.

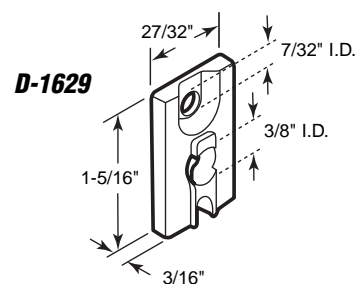

## D-1577

### Guides

**Contents:** 4 guides.

**Description:** Snap-in nylon guides for top of International series 900 patio doors.

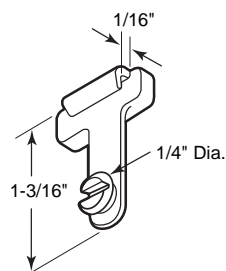

## D-1717

### Top Guides

**Contents:** 4 top guides.

**Description:** Nylon guide; snaps into top rail to facilitate smooth operation.

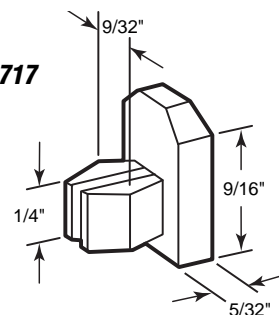

## D-1684

### Top Guides

**Contents:** 2 guides.

**Description:** Nylon guide mounts on top of door and prevents rattle during operation; fits on *International*.

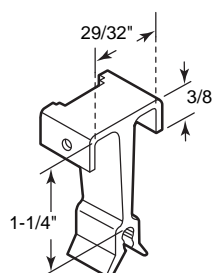

## D-1635

### Top Guides

**Contents:** 2 guides.

**Description:** Nylon guide; used by several patio door manufacturers.

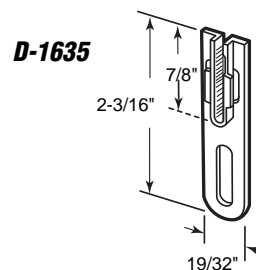

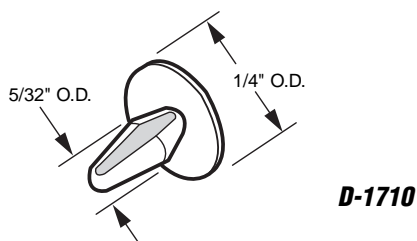
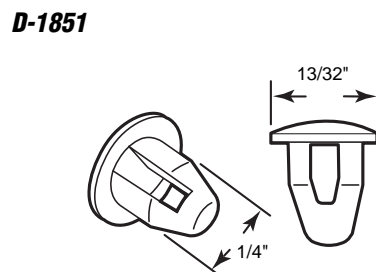
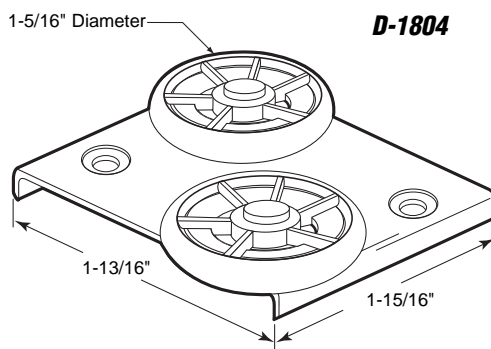
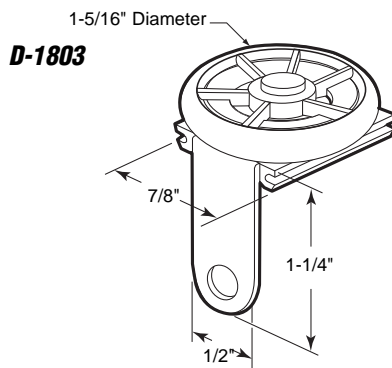

## D-1803

### Guide

**Contents:** 1 guide.

**Description:** Horizontal roller guide keeps door centered in top grooves for smooth operation, fits on *Peachtree* on *Citation 3* doors.

## D-1804

### Guide

**Contents:** 1 guide.

**Description:** Double horizontal roller guide for smooth operation, fits on *Peachtree* on *Carvel* doors.

## D-1851

### Guide

**Contents:** 4 guides.

**Description:** Nylon guides; snaps into top rail to facilitate smooth operation

Call for  
Availability

## D-1710

### Guide and Anti-Rattle Button

**Contents:** 4 guides.

**Description:** Nylon guide; used in top rail of door to create a quieter and smooth sliding patio door.

# Sliding Patio Door

## D-1702

### Bumper

**Contents:** 2 bumpers, installation fasteners.

**Description:** Rubber bumper mounted on steel "L" bracket; universal design.

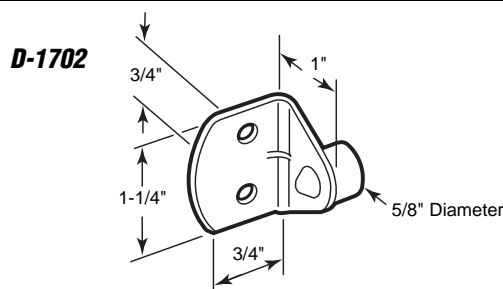

## D-1714

### Bumper

**Contents:** 4 bumpers, installation fasteners.

**Description:** Rubber bumper; reduces damage and noise; used by many manufacturers.

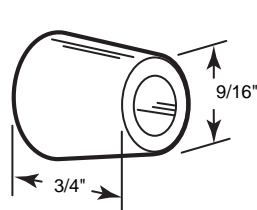

## D-1859

### Bumper

**Contents:** 2 bumpers, installation fasteners.

**Description:** Rubber bumper; attaches to jamb to cushion door.

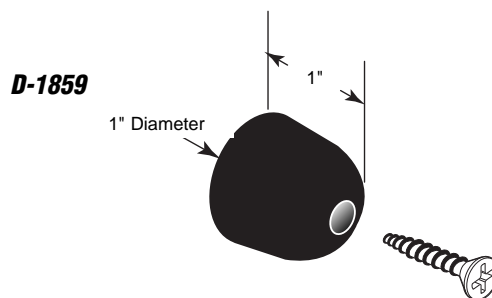

**D-1568** (Black)  
**D-1801** (White)

### Bumper

**Contents:** 2 bumpers, installation fasteners.

**Description:** Injected rubber bumper; attaches to jamb to protect door.

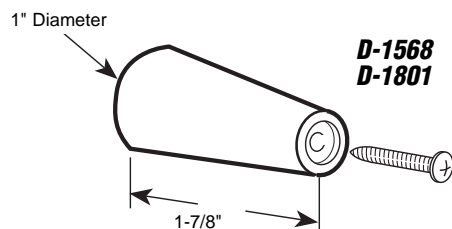

## D-1701

### Bumper

**Contents:** 2 bumpers, installation fasteners.

**Description:** Long injected rubber bumper; attaches to jamb to protect door.

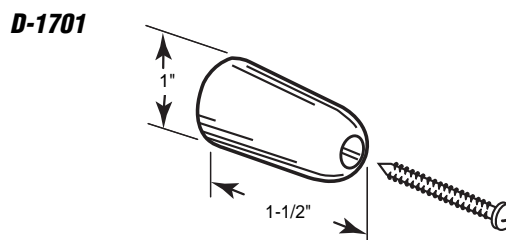

**D-1569** (Black)  
**D-1802** (White)

### Bumper

**Contents:** 2 bumpers, installation fasteners.

**Description:** Injected rubber bumper; attaches to jamb to protect door.

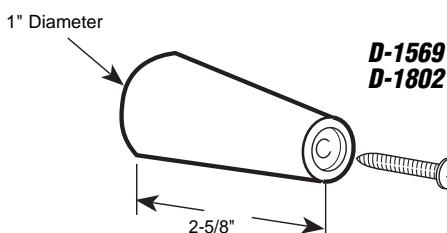

## D-1792

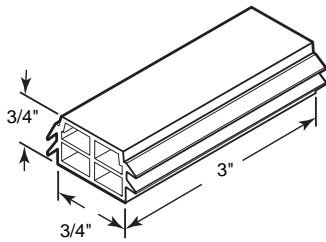

## D-1814

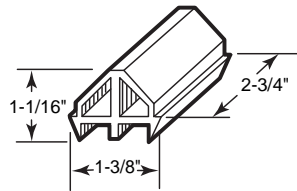
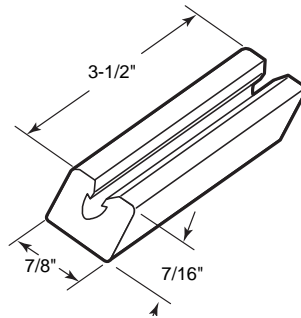

## D-1700

## D-1866

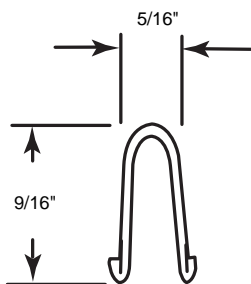
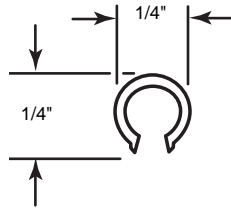

## D-1581 D-1582

## D-1583 D-1579 D-1580

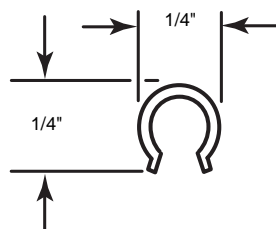

## D-1792

### Bumper

**Contents:** 2 bumpers.

**Description:** Long extruded rubber bumper; mounts into top frame rails to stop door; used by many manufacturers.

## D-1814

### Bumper

**Contents:** 1 bumper.

**Description:** Long extruded rubber bumper; mounts on sliding door track to help stop panel when being opened too hard.

## D-1700

### Bumper

**Contents:** 2 bumpers.

**Description:** Extruded rubber bumper; mounts into top and bottom frame rails to stop door; used by many manufacturers.

## D-1866

### Repair Track (Black)

**Contents:** 24' coil.

**Description:** Vinyl track cap; used to repair worn or damaged tracks; helps quiet doors as they slide.

## D-1581 (8 ft. Stainless steel)

## D-1582 (10 ft. Stainless steel)

### Repair Track

**Contents:** 1 track.

**Description:** Heavy duty track can be used by itself or as a repair track; can be used on wood or metal tracks.

**Note:** 5 piece minimum order.

## D-1583 (6 ft. Stainless steel)

## D-1579 (8 ft. Stainless steel)

## D-1580 (10 ft. Stainless steel)

### Repair Track

**Contents:** 1 track cap.

**Description:** Track cap is used as a repair part for damaged or badly worn tracks; easy to install.

**Note:** 10 piece minimum order.

Threshold Replacement Kits

A revolutionary new product that replaces oxidized or corroded patio door thresholds. Easy to install. Eliminates the need of replacing the entire door frame. Adapts to inside or outside slides.

**Contents of complete kit:** 5 pieces of extruded anodized aluminum, sisal paper, clear plastic sheeting, caulking, fasteners, razor blade and detailed instructions. Also available as a 5 piece extruded aluminum set only.

Type	Length	Anodized Aluminum	Anodized Bronze
Complete Kit	6'	D-1574	D-1644
	8'	D-1575	D-1645
	10'	D-1576	D-1646
	12'	D-1718	D-1719
5 Piece Extrusion Set Only	6'	D-1647	D-1648
	8'	D-1649	D-1650
	10'	D-1651	D-1652

**Note:** One set per carton.



Outside Slider Installation

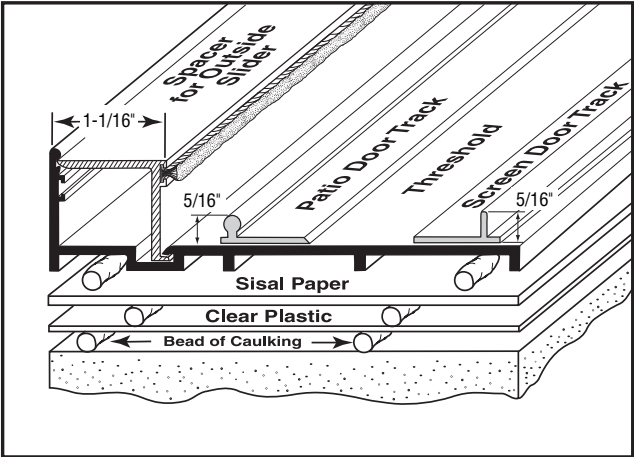

Inside Slider Installation

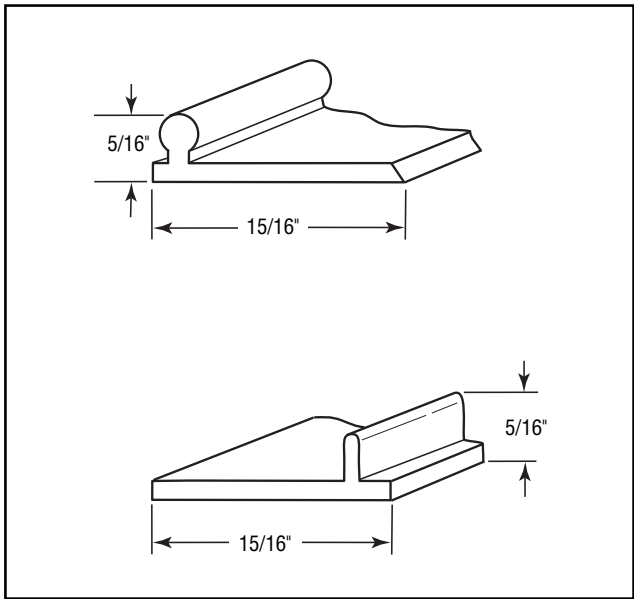
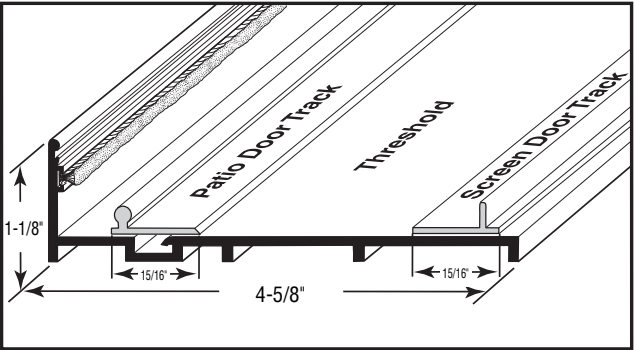

GLASS TRACK (ONLY)		
Length	Anodized Aluminum	Anodized Bronze
6'	D-1654	D-1669
8'	D-1659	D-1674
10'	D-1664	D-1679
12'	D-1743	D-1745
<b>Minimum order: 10 pcs. per box</b>		
SCREEN TRACK (ONLY)		
6'	D-1655	D-1670
8'	D-1660	D-1675
10'	D-1665	D-1680
12'	D-1744	D-1746
<b>Minimum order: 10 pcs. per box</b>		

